

The "Super 18" Beechcraft

## SUPPLEMENTAL PARTS CATALOG



THIS PUBLICATION SUPPLEMENTS AND IS TO BE USED IN  
CONJUNCTION WITH BEECH MODELS D18S AND  
D18C PARTS CATALOG 404-180151 ISSUED  
SEPTEMBER 1949

PUBLISHED BY  
THE CUSTOMER SERVICE DIVISION  
BEECH AIRCRAFT CORPORATION, WICHITA 1, KANSAS

## **WARNING**

This parts catalog has but one function: to facilitate ordering replacement parts for the Twin-Beech.

The illustrations in the catalog are keyed directly to the parts lists with which they are associated, to aid the user in locating the part he requires. In rendering these drawings, many details which were not essential for parts list identification purposes were omitted, for the sake of clarity. Likewise, in some instances detail sections of complex illustrations have been rotated in plane or their relative sizes changed, to show them more favorably on the printed page. No attempt has been made to show exactly the routing of control cables, plumbing, or wire harnesses, since such details would be difficult and costly to render on a single printed page and would serve no useful purpose in a parts catalog.

For the reasons given in the preceding paragraph, catalog illustrations are unsuitable, and were not intended, for use as guides to reassembly, routing or connections on plumbing, cables or wiring. Since many small details, such as attaching parts, have been omitted from the illustrations, the parts lists, rather than the illustrations, should be used to determine items, and quantities of each, required for a complete assembly.

The illustrations in the catalog should be used as aids in the identification of assemblies carried in their respective lists, and for no other purpose.

The catalog is not to be used as a maintenance reference.

## INTRODUCTION

### GENERAL.

This supplement to the D18S and D18C parts catalog is issued to provide coverage for E18S aircraft manufactured by Beech Aircraft Corporation, Wichita 1, Kansas. This supplement does not constitute a complete parts catalog, but details and/or illustrates only the installations, assemblies and detail parts of the E18S which differ from the D18S and D18C configuration as presented in the basic parts catalog. Therefore, to properly determine requirements of the E18S aircraft, this supplement must be used in conjunction with the basic parts catalog.

### METHOD OF COVERAGE.

The following paragraphs explain the manner employed in this supplement to cover the several situations present.

### IDENTICAL INSTALLATIONS.

Several installations used on the D18S aircraft are identical to those required for coverage of the E18S aircraft. Since this supplement provides coverage for only the differences between E18S and D18S - D18C aircraft, requirements of IDENTICAL INSTALLATIONS will be listed and illustrated only in the basic parts catalog.

### INSTALLATIONS WITH MINOR CHANGES

When the coverage required for E18S aircraft represents only minor changes in text, and the pictorial aspect is identical, the changes only are covered by text in this supplement and for additional text or illustration requirements the basic catalog must be used.

When the coverage required for E18S aircraft represents only minor changes in text, and the pictorial aspect is not identical in entirety, the changes only are covered by text and an illustration detail to the corresponding illustration in the basic catalog is shown in this supplement. Therefore, both the text and illustration changes being of a minor nature, the basic catalog must be used for additional requirements.

### INSTALLATIONS WITH MAJOR CHANGES

When the coverage required for E18S aircraft represents a major change in both text and illustration, then the applicable installation will be both listed and illustrated in this supplement.

## TABLE OF CONTENTS

| NOMENCLATURE                                  | FIGURE | PAGE |
|---|--------|------|
| Outboard Wing Assembly . . . . .              | 1      | 5    |
| Center Section Wing . . . . .                 | 2      | 6    |
| Tail Group . . . . .                          | 3      | 7    |
| Elevator Control System . . . . .             | 4      | 8    |
| Rudder Control System . . . . .               | 5      | 9    |
| Landing Gear Doors . . . . .                  | 6      | 12   |
| Landing Gear Strut Assembly. . . . .          | 7      | 14   |
| Tail Wheel Doors . . . . .                    | 8      | 15   |
| Tail Wheel Installation . . . . .             | 9      | 16   |
| Tail Wheel Details . . . . .                  | 10     | 17   |
| Strut Brake Piping and Hinge Pins. . . . .    | 11     | 19   |
| Goodyear Brake Assembly. . . . .              | 12     | 20   |
| Quick Engine Change Assembly . . . . .        | 13     | 22   |
| Engine Cylinder Baffles. . . . .              | 14     | 23   |
| Engine Exhaust System Jet Stack . . . . .     | 15     | 24   |
| Carburetor Air Duct and Scoops . . . . .      |        |      |
| Installation . . . . .                        | 16     | 26   |
| Lower Wrapper Sheets . . . . .                | 17     | 27   |
| Upper Cowling Assembly . . . . .              | 18     | 28   |
| Lower Cowling Assembly . . . . .              | 19     | 29   |
| Inner Cowl and Former Ring Assembly . . . . . | 20     | 31   |
| Firewall Assembly LH . . . . .                | 21     | 32   |
| Firewall Assembly RH . . . . .                | 22     | 33   |
| Fire Extinguisher System . . . . .            | 23     | 35   |
| Fuel System . . . . .                         | 24     | 36   |
| Engine Controls System . . . . .              | 25     | 37   |
| Control Pedestal Assembly . . . . .           | 26     | 38   |
| Body Windows and Windshield. . . . .          | 27     | 39   |
| Pilot's Floorboards . . . . .                 | 28     | 41   |
| Cabin Chair - Reclining. . . . .              | 29     | 43   |
| Cabin Door Assembly . . . . .                 | 30     | 44   |
| Nose Door Cap . . . . .                       | 31     | 45   |
| Bulkhead Doors and Escape Panel. . . . .      | 32     | 46   |
| Body Interior Furnishings. . . . .            | 33     | 48   |
| Bladder Nose Fuel Tank . . . . .              | 34     | 51   |
| Standard Instrument Panel . . . . .           | 35     | 53   |
| Pitot Static System . . . . .                 | 36     | 56   |
| Heater Installation . . . . .                 | 37     | 58   |
| Cold Air and Heater Ducts. . . . .            | 38     | 61   |
| Deicer Boots Installation. . . . .            | 39     | 63   |
| Deicer Plumbing Installation . . . . .        | 40     | 65   |
| Deicer Plumbing Detail . . . . .              | 41     | 68   |
| Miscellaneous Electrical Equipment . . . . .  | 42     | 70   |
| Subpanel Assembly Left and Right . . . . .    | 43     | 71   |
| Miscellaneous Tools and Equipment. . . . .    | 44     | 73   |

**PARTS LIST**

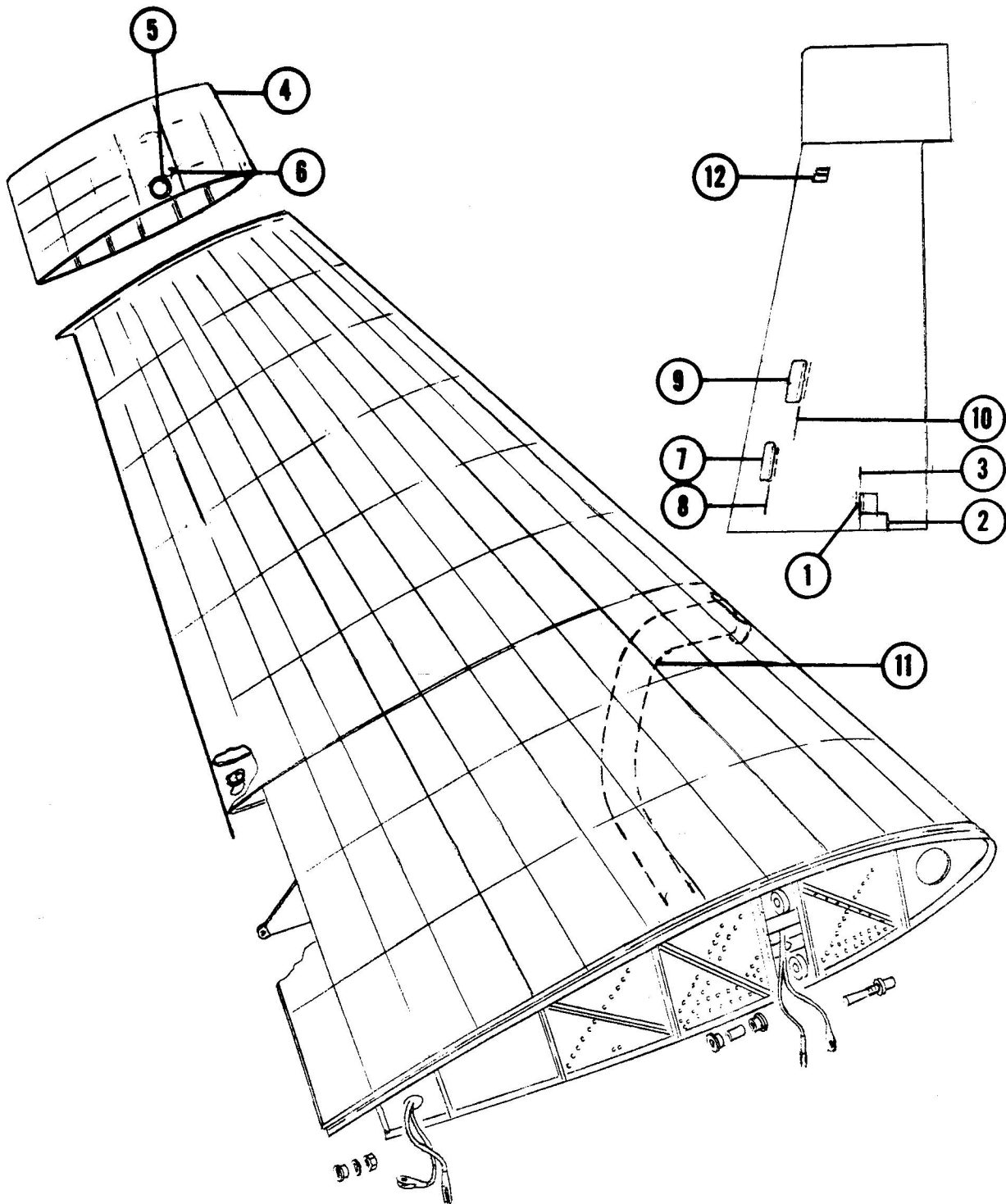

Fig. 1 Outboard Wing Assembly

## Outboard Wing Assembly

| Fig. | Index | PART NUMBER  | NOMENCLATURE                | Units Per<br>Assem.                        |   |
|------|-------|--------------|-----------------------------|--|---|
| 1    |       | 414-181200-1 | Wing Assembly - Outboard LH | 1  |   |
|      |       | 414-181200-2 | Wing Assembly - Outboard RH | 1  |   |
|      |       | 1            | 414-181200-9                | Door - Outboard Wing<br>(RH only)          | 1 |
|      |       | 2            | 414-181200-11               | Door - Outboard Wing<br>(RH only)          | 1 |
|      |       | 3            | AN253-2-2850                | Pin - Hinge                                | 1 |
|      |       | 4            | 414-185000-1                | Tip Assembly - Outboard<br>Wing LH         | 1 |
|      |       |              | 414-185000-2                | Tip Assembly - Outboard<br>Wing RH         | 1 |
|      |       | 5            | 414-185000-53               | Cover - Wing Tip Inspection                | 2 |
|      |       | 6            | AN515-8R8                   | Screw                                      | 8 |
|      |       | 7            | 414-181200-41               | Door Assembly - Heater<br>Access (RH only) | 1 |
|      |       | 8            | AN235-2-1300                | Pin - Hinge                                | 1 |
|      |       | 9            | 414-181200-43               | Door - Deicer Boot Access LH               | 1 |
|      |       |              | 414-181200-44               | Door - Deicer Boot Access RH               | 1 |
|      |       | 10           | 414-181200-51               | Pin - Hinge                                | 1 |
|      |       | 11           | 414-183958-1                | Scoop - Wing Heater Air<br>(RH only)       | 1 |
|      |       |              | 414-181200-63               | Lug Assembly - Mooring                     | 2 |

## Center Section Wing

| Fig. | Index | PART NUMBER                | NOMENCLATURE  | Units Per Assem. |
|------|-------|----------------------------|---|------------------|
| 2    |       | 414-181100                 | Wing Assembly - Center Section                      | 1                |
|      |       | 414-181100-29              | Compartment Installation -<br>Battery LH            | 1                |
|      |       | 414-181100-30              | Compartment Installation -<br>Battery RH            | 1                |
|      |       | 414-181100-63              | Cover Assembly LH - Battery<br>Compartment          | 1                |
|      |       | 414-181100-64              | Cover Assembly RH - Battery<br>Compartment          | 1                |
|      |       | 414-181100-15              | Frame Assembly LH - Battery<br>Support              | 1                |
|      |       | 414-189411                 | Box Assembly - Battery                              | 1                |
|      |       | AN526-832-6                | Screw   | 8                |
|      |       | 180961                     | Power Box Assembly - External<br>LH                 | 1                |
|      |       | 180966                     | Door Assembly - External Power<br>Box LH            | 1                |
|      |       | 180960                     | Lid - External Power Box LH                         | 1                |
|      |       | 414-185960                 | Mechanism Installation - Landing<br>Gear Doors      | 1                |
|      |       | 414-185862                 | Spring - Landing Gear Door<br>Mechanism             | 4                |
|      |       | 414-185960-29              | Mechanism Assembly - Landing<br>Gear Doors Inboard  | 2                |
|      |       | 414-185960-31              | Mechanism Assembly - Landing<br>Gear Doors Outboard | 2                |
|      |       | 414-185967                 | Slide - Landing Gear Doors<br>Mechanism             | 2                |
|      |       | 414-185966                 | Catch Assembly - Landing<br>Gear Door Mechanism     | 2                |
|      |       | 414-185964                 | Roller Assembly - Landing Gear<br>Door Mechanism    | 6                |
|      |       | 105739-X0250-<br>0372-0378 | Bushing   | 12               |
|      |       | 414-185963                 | Bolt - Landing Gear Door<br>Mechanism Roller        | 2                |
|      |       | 414-185965-5               | Rod Assembly - Landing Gear<br>Mechanism Inboard    | 2                |
|      |       | 414-185965-3               | Rod Assembly - Landing Gear<br>Mechanism Outboard   | 2                |



Tail Group

| Fig. | Index | PART NUMBER   | NOMENCLATURE                                  | Units Per Assem. |
|------|-------|---------------|---|------------------|
| 3    |       | 414-186000    | Tail Surface Installation                     | 1                |
|      |       | 414-186050    | Stabilizer Assembly -<br>Horizontal           | 1                |
|      |       | 414-186000-13 | Fillet Assembly - Horizontal<br>Stabilizer LH | 1                |
|      |       | 414-186000-14 | Fillet Assembly - Horizontal<br>Stabilizer RH | 1                |
|      |       | 414-186000-3  | Fairing - Horizontal<br>Stabilizer            | 1                |
|      |       | 414-186000-15 | Cone - Tail Inner                             | 1                |
|      |       | 414-186200-1  | Fin Assembly LH                               | 1                |
|      |       | 414-186200-2  | Fin Assembly RH                               | 1                |

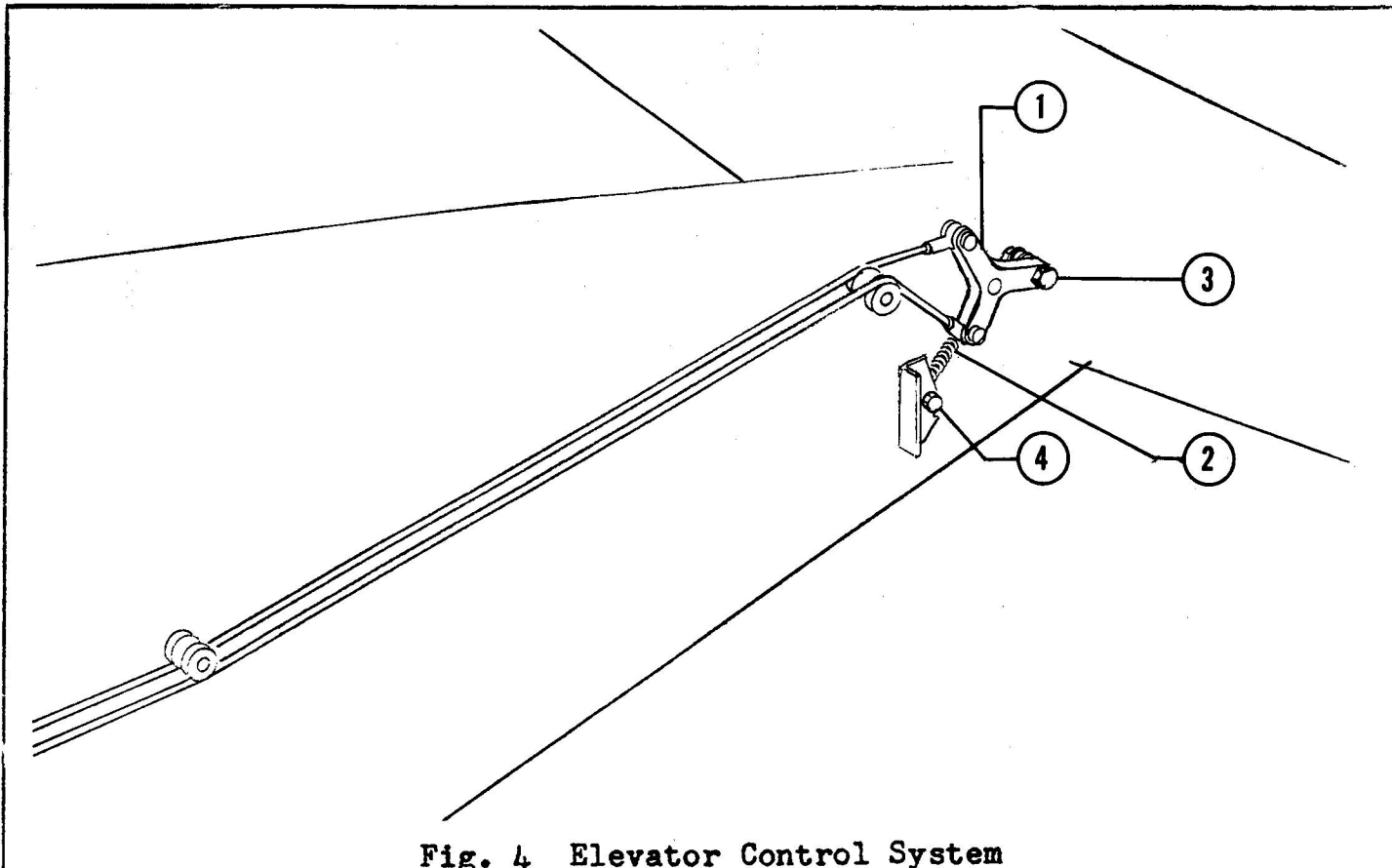

Fig. 4 Elevator Control System

| Fig. | Index | PART NUMBER       | NOMENCLATURE                   | Units Per Assem. |
|------|-------|-------------------|--------------------------------|------------------|
| 4    |       | 414-187000        | Controls Installation - Flight | 1                |
|      | 1     | 414-186138        | Bellcrank Assembly - Elevator  | 1                |
|      | 2     | 414-187003        | Spring - Elevator Down         | 1                |
|      | 3     | AN4-H26(M)        | Bolt                           | 1                |
|      |       | AN970-4           | Washer                         | 1                |
|      |       | 100696-S12-08-008 | Spacer                         | 1                |
|      | 4     | AN24-10           | Bolt                           | 1                |
|      |       | AN310-4           | Nut                            | 1                |
|      |       | AN380-2-2         | Pin                            | 1                |
|      |       | 414-187097        | Cable Assembly - Elevator      | 1                |

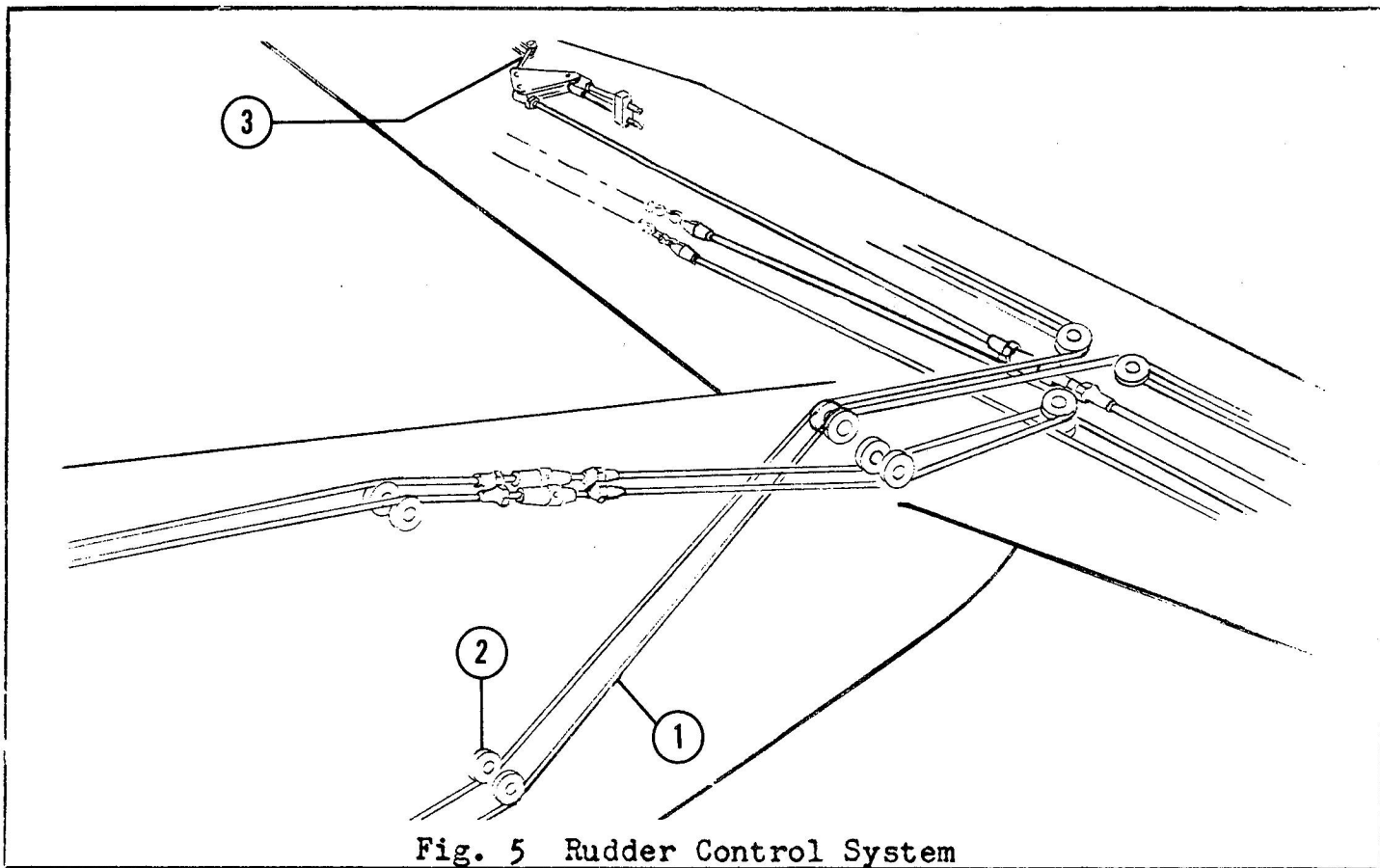

Fig. 5 Rudder Control System

| Fig. | Index | PART NUMBER | NOMENCLATURE                   | Units Per Assem. |
|------|-------|-------------|--------------------------------|------------------|
| 5    |       | 414-187000  | Controls Installation - Flight | 1                |
|      | 1     | 414-187011  | Cable Assembly - Rudder Long   | 2                |
|      | 2     | AN210-3A    | Pulley - Rudder Cable Control  | 2                |
|      |       | S-126-20(M) | Bolt                           | 2                |
|      |       | AN960-416L  | Washer                         | 2                |
|      |       | AN320-4     | Nut                            | 2                |
|      |       | AN380-2-2   | Pin                            | 2                |
|      | 3     | 414-186160  | Link Assembly - RH side only   | 1                |
|      |       | 414-187718  | Control Installation - Rudder  |                  |
|      |       | 187803      | Tab                            | 1                |
|      |       |             | Housing - Rudder Tab           |                  |
|      |       |             | Control                        | 1                |
|      |       | 404-187770  | Shaft - Tab Control            | 1                |
|      |       | 6A702342    | Handle Assembly - Rudder       |                  |
|      |       |             | Tab Control                    | 1                |
|      |       | 187732      | Pulley - Rudder Tab Control    | 2                |
|      |       | 404-187719  | Indicator Assembly - Rudder    |                  |
|      |       |             | Tab Control                    | 1                |
|      |       | 404-187723  | Shaft Assembly - Rudder        |                  |
|      |       |             | Tab Indicator                  | 1                |
|      |       | 407-187803  | Housing - Rudder Tab           |                  |
|      |       |             | Indicator                      | 1                |
|      |       | 404-187724  | Pinion - Rudder Tab            |                  |
|      |       |             | Indicator                      | 1                |
|      |       | 404-187722  | Pinion - Rudder Tab            |                  |
|      |       |             | Indicator                      | 1                |
|      |       | 404-187725  | Bushing - Rudder Tab           |                  |
|      |       |             | Indicator                      | 1                |

| Fig. | Index | PART NUMBER  | NOMENCLATURE                 | Units Per<br>Assem. |
|------|-------|--------------|------------------------------|---------------------|
| 5    |       | 404-187720   | Plate - Rudder Tab           |                     |
|      |       | 187827       | Indicator                    | 1                   |
|      |       | #1           | Pin - Rudder Tab Indicator   | 1                   |
|      |       | 694-187732   | Escutcheon - Rudder Tab      |                     |
|      |       | 404-187741   | Control Handle               | 1                   |
|      |       | 407-187732-4 | Spacer - Rudder Tab Control  | 1                   |
|      |       | 414-187701   | Plate - Rudder Tab Control   | 1                   |
|      |       | 209          | Dial - Rudder Tab Control    | 1                   |
|      |       | AN3121-R313  | Support - Rudder Tab Control | 1                   |
|      |       |              | Socket                       | 1                   |
|      |       |              | Lamp                         | 1                   |

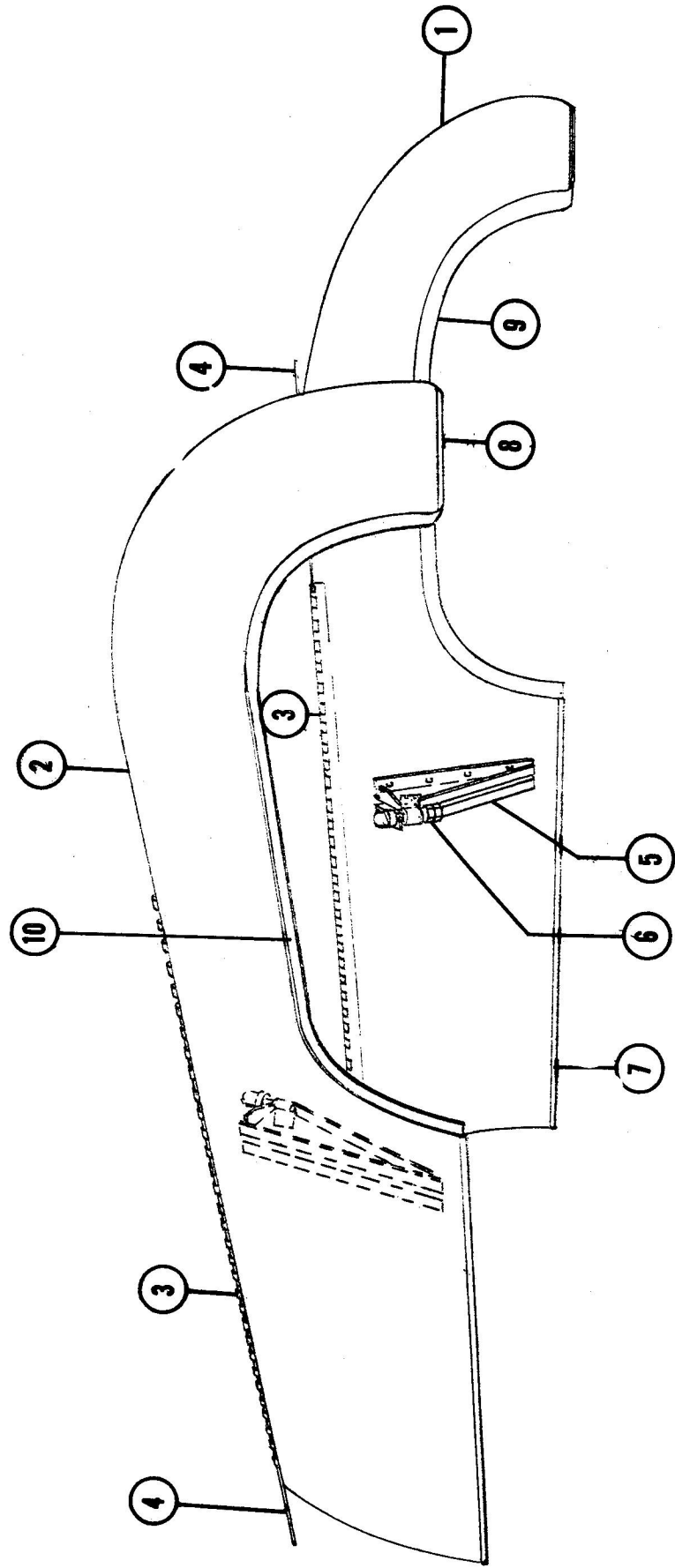

Fig. 6 Landing Gear Doors

## Landing Gear Doors

| Fig. | Index | PART NUMBER   | NOMENCLATURE                                  | Units Per Assem. |
|------|-------|---------------|---|------------------|
| 6    |       | 414-185951-1  | Door Installation - Landing Gear LH           | 1                |
|      |       | 414-185951-2  | Door Installation - Landing Gear RH           | 1                |
|      | 1     | 414-185951-15 | Door Assembly - Main Landing Gear LH Inboard  | 1                |
|      |       | 414-185951-16 | Door Assembly - Main Landing Gear RH Inboard  | 1                |
|      | 2     | 414-185951-17 | Door Assembly - Main Landing Gear LH Outboard | 1                |
|      |       | 414-185951-18 | Door Assembly - Main Landing Gear RH Outboard | 1                |
|      | 3     | 414-185951-31 | Hinge - LH Inboard                            | 1                |
|      |       | 414-185951-32 | Hinge - RH Inboard                            | 1                |
|      |       | 414-185951-33 | Hinge - LH Outboard                           | 1                |
|      |       | 414-185951-34 | Hinge - RH Outboard                           | 1                |
|      | 4     | 414-185951-35 | Pin - Hinge Inboard                           | 2                |
|      |       | 414-185951-37 | Pin - Hinge Outboard                          | 2                |
|      | 5     | 414-185951-7  | Bracket Assembly - Door Retract Inboard       | 2                |
|      |       | 414-185951-9  | Bracket Assembly - Door Retract Outboard      | 2                |
|      | 6     | 414-185954    | Fitting - Door Retract                        | 4                |
|      | 7     | 414-185951-23 | Seal - Landing Gear Door                      | 1                |
|      | 8     | 414-185951-25 | Seal - Landing Gear Door                      | 1                |
|      | 9     | 414-185951-47 | Seal - Landing Gear Door                      | 1                |
|      | 10    | 414-185951-49 | Seal - Landing Gear Door                      | 1                |

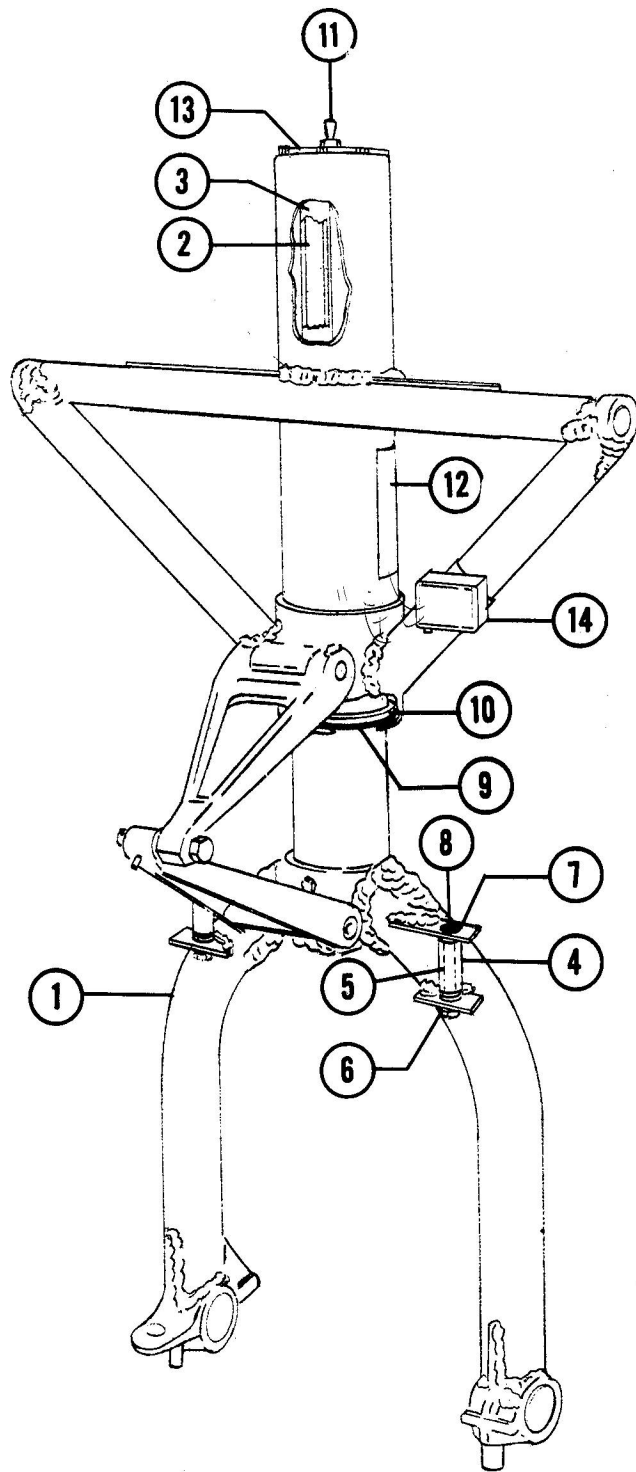

Fig. 7 Landing Gear Strut Assembly

## Landing Gear Strut Assembly

| Fig. | Index | PART NUMBER            | NOMENCLATURE                               | Units Per Assem. |
|------|-------|------------------------|--|------------------|
| 7    |       | 414-188400             | Absorber Assembly - Landing Gear Shock     | 1                |
|      | 1     | 414-188402             | Piston and Fork Assembly - Landing Gear    | 1                |
|      | 2     | 414-188487             | Control Assembly - Landing Gear Shock      | 1                |
|      | 3     | 414-188433             | Cylinder Assembly - Landing Gear Shock     | 1                |
|      | 4     | 414-188002             | Roller Assembly - Landing Gear Door Uplock | 1                |
|      | 5     | 105739-X0375-0560-3312 | Bushing                                    | 1                |
|      | 6     | 100951-X093-012-100    | Washer                                     | 1                |
|      | 7     | 100951-X032-012-100    | Washer                                     | 1                |
|      | 8     | AN6-43A                | Bolt                                       | 1                |
|      |       | AN365-624              | Nut  | 1                |
|      | 9     | 111190-20              | Ring                                       | 1                |
|      | 10    | 114941                 | Ring                                       | 1                |
|      | 11    | AN6287-1               | Valve Assembly - High Pressure Air         | 1                |
|      | 12    | 414-180193             | Placard - Landing Gear Shock Strut         | 1                |
|      | 13    | 414-188438             | Cap Assembly - Landing Gear Cylinder       | 1                |
|      | 14    | BZ-RQ-41               | Switch - Landing Gear Safety               | 1                |



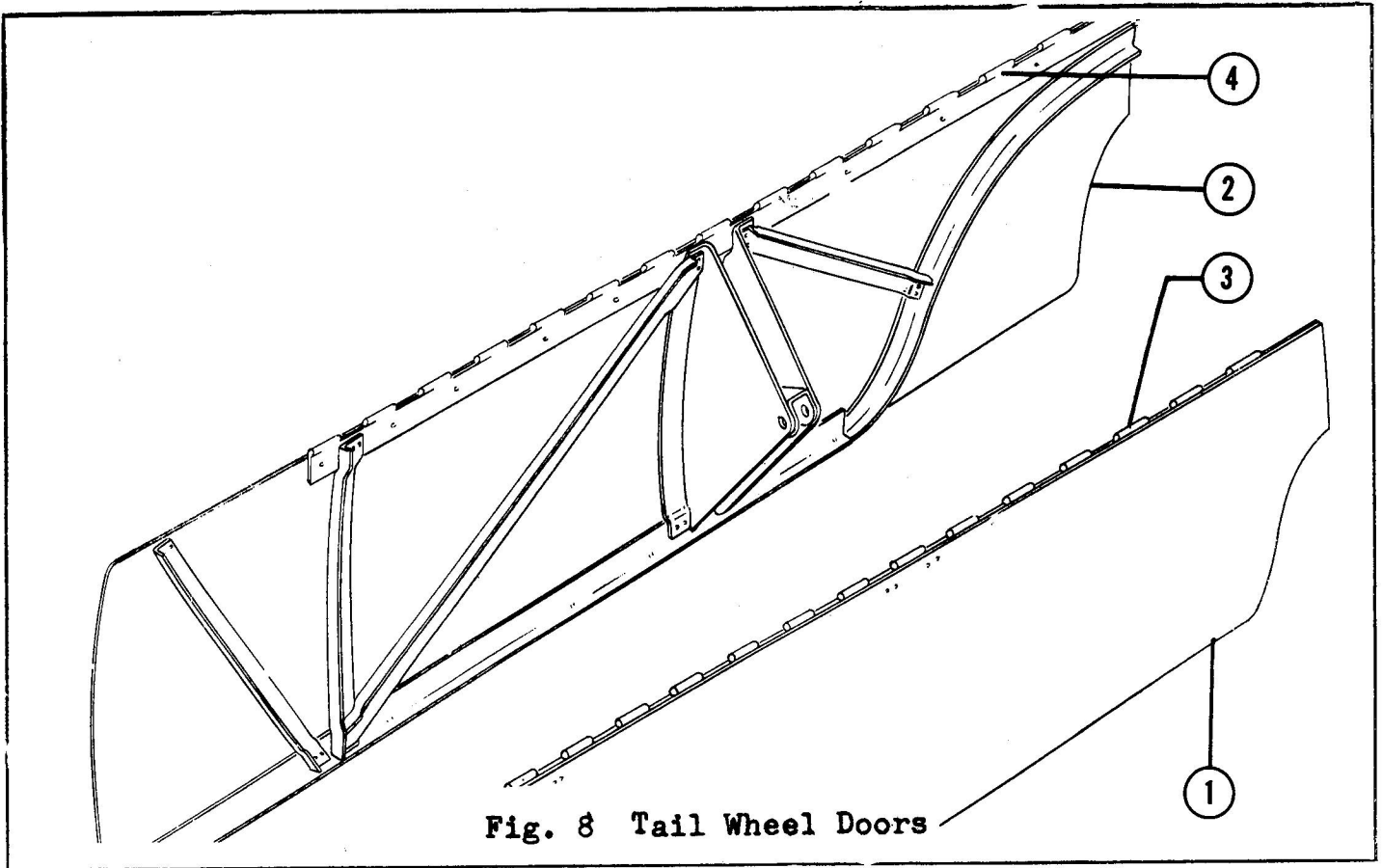

Fig. 8 Tail Wheel Doors

| Fig. | Index | PART NUMBER   | NOMENCLATURE               | Units Per Assem. |
|------|-------|---------------|----------------------------|------------------|
| 8    |       | 414-185961    | Door Assembly - Tail Wheel | 2                |
|      | 1     | 414-185961-5  | Door - Tail Wheel LH       | 1                |
|      | 2     | 414-185961-6  | Door - Tail Wheel RH       | 1                |
|      | 3     | 414-185961-15 | Hinge - Tail Wheel Door LH | 1                |
|      | 4     | 414-185961-16 | Hinge - Tail Wheel Door RH | 1                |

## Tail Wheel Installation

| Fig. | Index | PART NUMBER  | NOMENCLATURE                | Units Per<br>Assem. |
|------|-------|--------------|-----------------------------|---------------------|
| 9    |       | 414-188660   | Wheel Installation - Tail   | 1                   |
|      |       | 414-188660-3 | Truss and Fork Assembly     | 1                   |
|      |       | 414-188660-7 | Truss Assembly - Tail Wheel | 1                   |
|      |       | 414-188660-5 | Fork Assembly - Tail Wheel  | 1                   |

# Tail Wheel Details

| Fig. | Index | PART NUMBER | NOMENCLATURE                        | Units Per Assem. |
|------|-------|-------------|-------------------------------------|------------------|
| 10   |       | 414-188660  | Control Installation - Tail Wheel   | 1                |
|      |       | 414-188655  | Cable Assembly - Tail Wheel Retract | 1                |

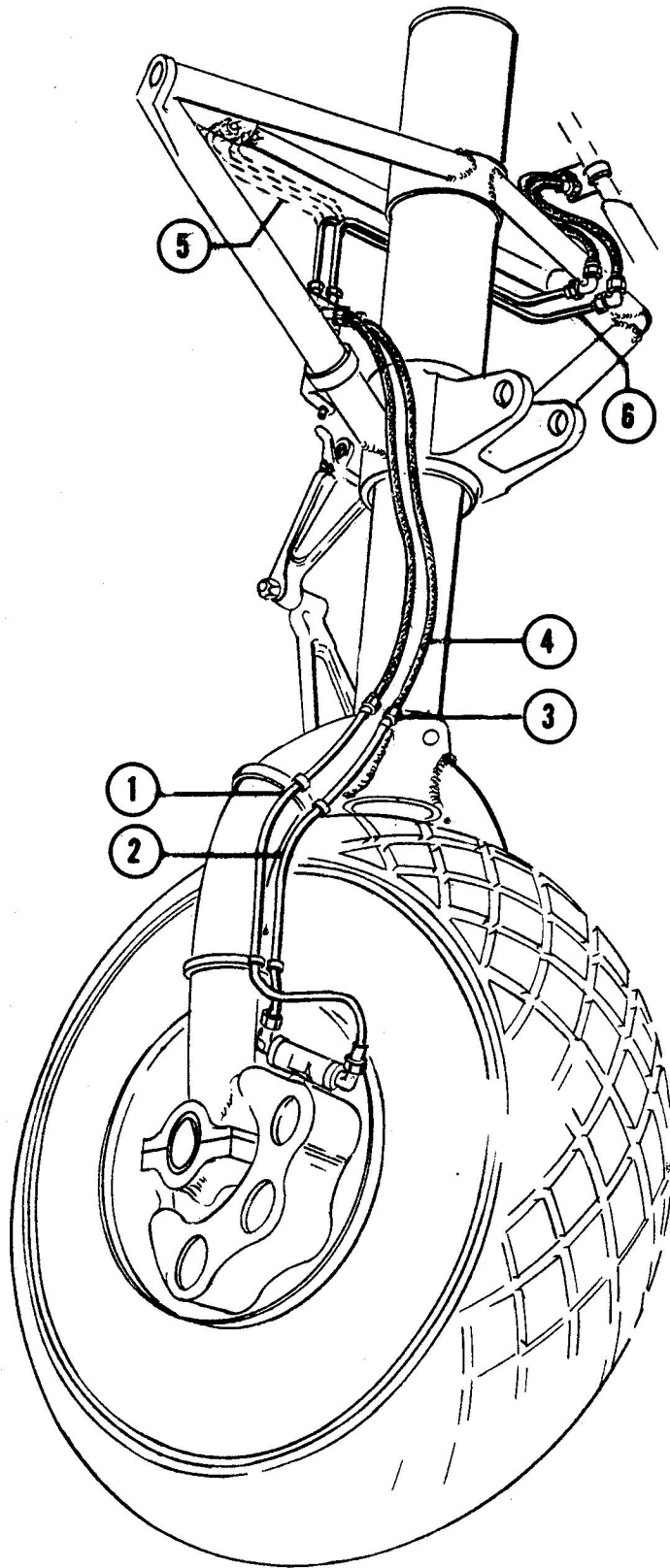

**Fig. 11 Strut Brake Piping and Hinge Pins**

Fig. 11 Strut Brake Piping and Hinge Pins

| Fig. | Index | PART NUMBER   | NOMENCLATURE                        | Units Per Assem. |
|------|-------|---------------|-------------------------------------|------------------|
| 11   |       | 414-188000-1  | Gear Installation - Main Landing LH | 1                |
|      |       | 414-188000-2  | Gear Installation - Main Landing RH | 1                |
|      | 1     | 414-188000-13 | Tube Assembly - Brake LH            | 1                |
|      |       | 414-188000-15 | Tube Assembly - Brake RH            | 1                |
|      | 2     | 414-188000-17 | Tube Assembly - Brake LH            | 1                |
|      |       | 414-188000-19 | Tube Assembly - Brake RH            | 1                |
|      | 3     | AN815-4D      | Union                               | 2                |
|      | 4     | MS28741-4     | Hose Assembly - Brake               | 2                |
|      | 5     | 414-188000-5  | Tube Assembly - Brake LH            | 1                |
|      |       | 414-188000-9  | Tube Assembly - Brake RH            | 1                |
|      | 6     | 414-188000-7  | Tube Assembly - Brake LH            | 1                |
|      |       | 414-188000-11 | Tube Assembly - Brake RH            | 1                |

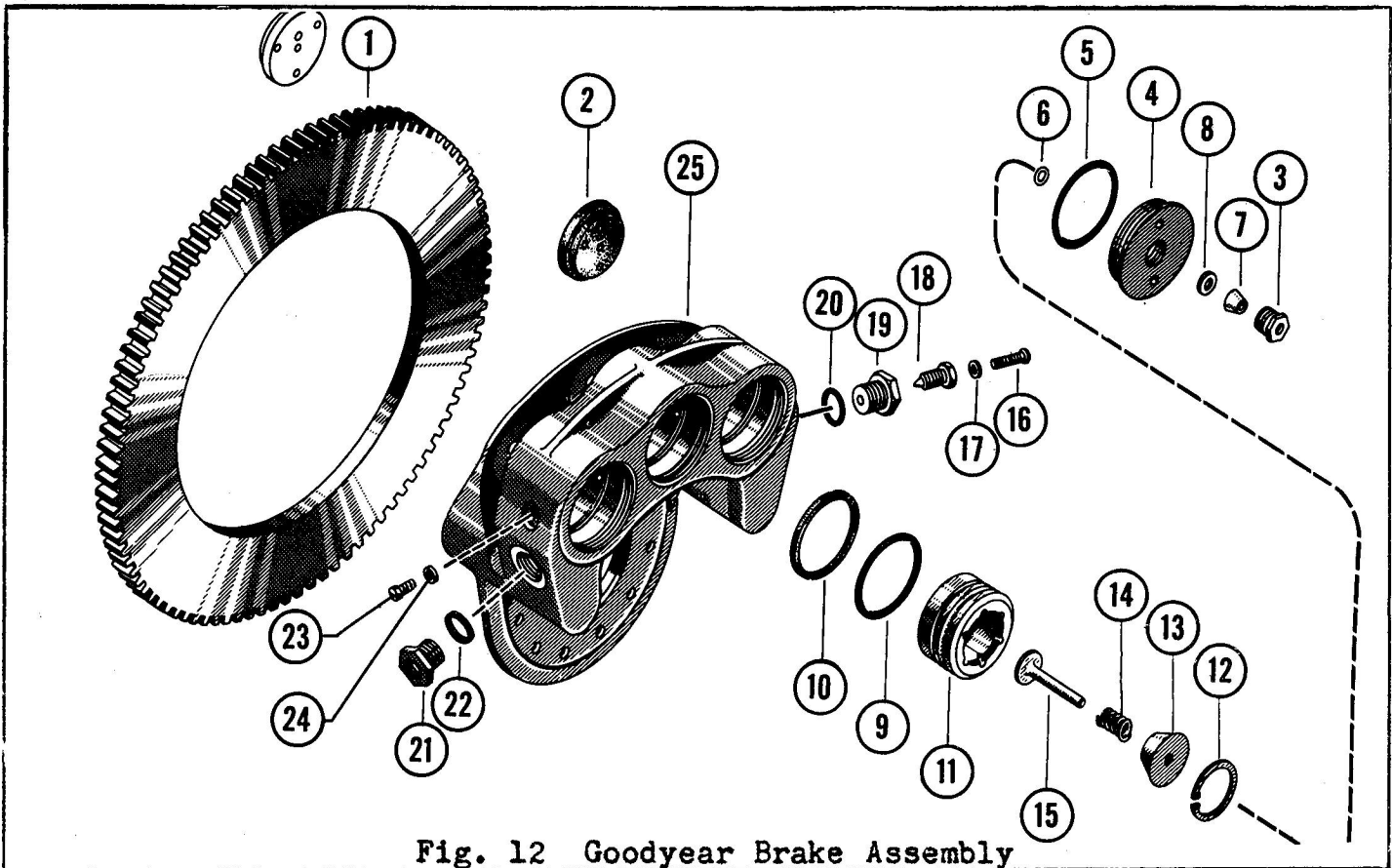

Fig. 12 Goodyear Brake Assembly

| Fig. | Index | PART NUMBER | NOMENCLATURE                                 | Units Per Assem. |
|------|-------|-------------|--|------------------|
| 12   |       | 530886SG    | Brake Assembly - Gear Type (Goodyear)        | 1                |
|      | 1     | 9530993     | Disc - Gear Brake (Goodyear)                 | 1                |
|      | 2     | 9521604     | Lining - Gear Type Brake (Goodyear)          | 6                |
|      | 3     | 9510894     | Nut - Adjustment Pin (Goodyear)              | 3                |
|      | 4     | 9521603     | Head - Cylinder (Goodyear)                   | 3                |
|      | 5     | AN6230-6    | Ring - "0"                                   | 3                |
|      | 6     | AN6227-5    | Ring - "0"                                   | 3                |
|      | 7     | 9510895     | Grip - Adjustment Pin (Goodyear)             | 3                |
|      | 8     | 511820-7    | Washer - Adjusting Pin (Goodyear)            | 3                |
|      | 9     | AN6227-30   | Ring - "0"                                   | 3                |
|      | 10    | 511809-6    | Wiper - Felt (Goodyear)                      | 3                |
|      | 11    | 511921M     | Piston - Brake Cylinder (Goodyear)           | 3                |
|      | 12    | NAS50-137P  | Ring - Spring Plate Retainer                 | 3                |
|      | 13    | 511812-A    | Plate - Spring Retaining Moveable (Goodyear) | 3                |
|      | 14    | 511811      | Spring - Brake Release (Goodyear)            | 3                |
|      | 15    | 511810      | Pin - Self Adjusting (Goodyear)              | 3                |
|      | 16    | AN520-10-5  | Screw - Bleeder                              | 1                |

| Fig. | Index | PART NUMBER | NOMENCLATURE                          | Units Per Assem. |
|------|-------|-------------|---------------------------------------|------------------|
| 12   | 17    | 511846-4    | Washer - Bleeder (Goodyear)           | 3                |
|      | 18    | AN6204-1    | Valve - Bleeder                       | 1                |
|      | 19    | 9511157     | Adapter - Bleeder Valve               | 1                |
|      | 20    | AN6290-8    | Gasket - Bleeder and Inlet            | 1                |
|      | 21    | 512054      | Bushing - Inlet (Goodyear)            | 1                |
|      | 22    | AN6290-8    | Gasket - Bleeder and Inlet (Goodyear) | 1                |
|      | 23    | AN501-A10-4 | Screw                                 | 2                |
|      | 24    | 511846-4    | Washer - Bleeder (Goodyear)           | 3                |
|      | 25    | 9540666     | Housing - Brake (Goodyear)            | 1                |

## Quick Engine Change Assembly

| Fig. | Index | PART NUMBER  | NOMENCLATURE                          | Units Per<br>Assem. |
|------|-------|--------------|---------------------------------------|---------------------|
| 13   |       | 414-189001   | Power Plant Installation              | 1                   |
|      |       | 414-189001-1 | Engine Assembly - LH                  | 1                   |
|      |       | 414-189001-2 | Engine Assembly - RH                  | 1                   |
|      |       | 414-185901   | Cowling Assembly - Engine             | 1                   |
|      |       | 414-189110-1 | Baffle Installation - Engine<br>LH    | 1                   |
|      |       | 414-189110-2 | Baffle Installation - Engine<br>RH    | 1                   |
|      |       | 414-189200   | Exhaust System Installation<br>Engine | 2                   |
|      |       | 22D30-305    | Propeller Assembly - Hydro-<br>matic  | 2                   |
|      |       | 22D30        | Hub - Propeller                       | 2                   |
|      |       | 6531A-15     | Blade Assembly - Propeller            | 2                   |
|      |       | 4B2P6        | Governor Assembly - Propeller         | 2                   |
|      |       | 189021       | Gasket - Propeller Governor           | 2                   |
|      |       | 1001G-01     | Generator - Tachometer                | 2                   |



# Engine Cylinder Baffles

| Fig. | Index | PART NUMBER  | NOMENCLATURE                         | Units Per Assem. |
|------|-------|--------------|--------------------------------------|------------------|
| 14   |       | 414-189110-1 | Baffle Installation - Engine<br>LH   | 1                |
|      |       | 414-189110-2 | Baffle Installation - Engine<br>RH   | 1                |
|      |       | 39982        | Baffle Assembly - Inter-<br>Cylinder | 1                |

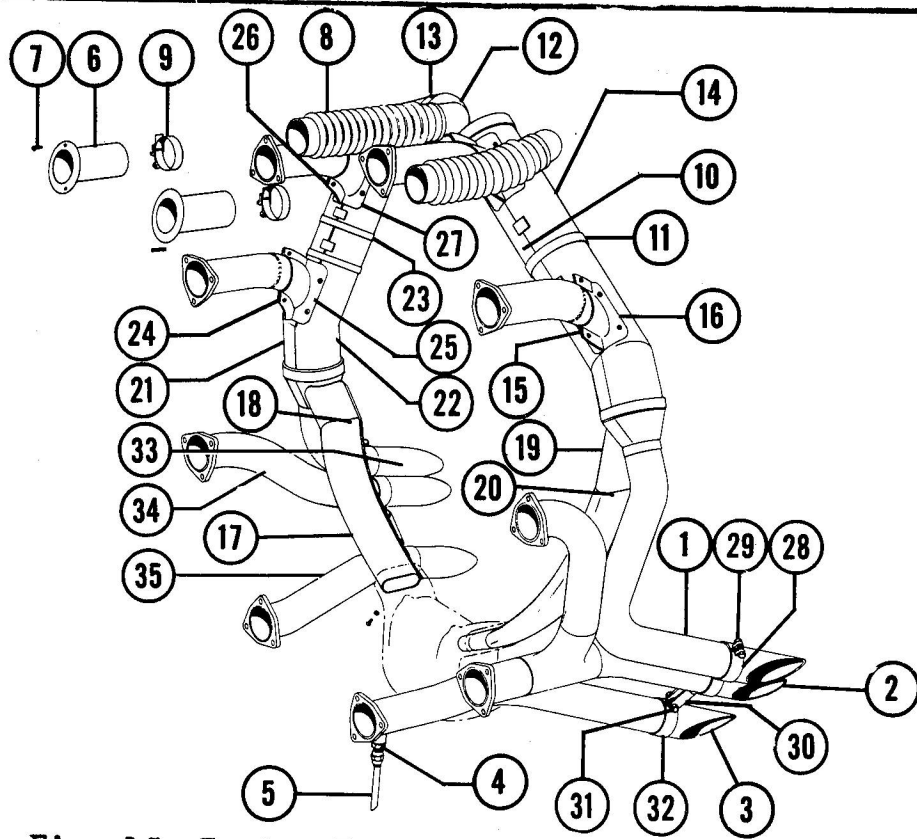

Fig. 15 Engine Exhaust System Jet Stack

| Fig. | Index | PART NUMBER      | NOMENCLATURE                                     | Units Per Assem. |
|------|-------|------------------|--|------------------|
| 15   |       | 414-189200       | Exhaust System Installation -<br>Jet Stack       | 1                |
|      | 1     | 414-189206       | Stack Assembly - Exhaust<br>LH                   | 1                |
|      | 2     | 414-189205       | Stack Assembly - Exhaust<br>LH                   | 1                |
|      | 3     | 414-189204       | Stack Assembly - Exhaust<br>LH                   | 1                |
|      | 4     | AN816-7          | Nipple   | 1                |
|      | 5     | 414-189200-19    | Tube Assembly - Exhaust<br>Sampler               | 1                |
|      | 6     | 189224           | Inlet - Cold Air                                 | 2                |
|      | 7     | AN515-8-7        | Screw  | 2                |
|      | 8     | 111716-AX-XX-5-6 | Duct - Cold Air Inlet LH                         | 1                |
|      | 9     | 111716-AX-XX-5-9 | Duct - Cold Air Inlet RH                         | 1                |
|      | 9     | 105798-10        | Clamp  | 2                |
|      | 10    | 414-189166       | Shell Assembly - Inner<br>Carburetor Heat Muff   | 1                |
|      | 11    | 105798-12        | Clamp  | 2                |
|      | 12    | 414-189168-11    | Cap - Carburetor Heat Muff LH                    | 1                |
|      |       | 414-189168-9     | Cap - Carburetor Heat Muff RH                    | 1                |
|      | 13    | AN515-8-6        | Screw  | 2                |
|      | 14    | 414-189165       | Shell Assembly - Outer Car-<br>buretor Heat Muff | 1                |

| Fig. | Index | PART NUMBER   | NOMENCLATURE                                | Units Per Assem. |
|------|-------|---------------|---|------------------|
| 15   | 15    | 414-189200-13 | Collar - Carburetor Heat Muff               | 1                |
|      | 16    | 414-189200-15 | Collar - Carburetor Heat Muff               | 1                |
|      | 17    | 414-189161    | Duct - Carburetor Heat                      | 1                |
|      | 18    | AN515-8-6     | Screw                                       | 2                |
|      | 19    | 414-189162    | Duct - Carburetor Heat                      | 1                |
|      | 20    | AN 515-8-6    | Screw - Carburetor Heat                     | 1                |
|      | 21    | 414-189163    | Shell Assembly - Outer Carburetor Heat Muff | 1                |
|      | 22    | 414-189164    | Shell Assembly - Inner Carburetor Heat Muff | 1                |
|      | 23    | 105798-12     | Clamp                                       | 3                |
|      | 24    | 414-189200-5  | Collar - Carburetor Heat Muff               | 1                |
|      | 25    | 414-189200-7  | Collar - Carburetor Heat Muff               | 1                |
|      | 26    | 414-189200-9  | Collar - Carburetor Heat Muff               | 1                |
|      | 27    | 414-189200-11 | Collar - Carburetor Heat Muff               | 1                |
|      | 28    | 414-189200-1  | Clamp Assembly - Exhaust Stack              | 2                |
|      | 29    | AN4-6A        | Bolt  | 2                |
|      | 30    | 414-189200-3  | Strap - Exhaust Stack                       | 4                |
|      | 31    | AN4-7A        | Bolt  | 2                |
|      | 32    | PP-561-S-17   | Clamp - Exhaust Stack                       | 2                |
|      | 33    | 414-189201    | Stack Assembly - Exhaust RH                 | 1                |
|      | 34    | 414-189202    | Stack Assembly - Exhaust RH                 | 1                |
|      | 35    | 414-189203    | Stack Assembly - Exhaust RH                 | 1                |

# Carburetor Air Duct and Scoops Installation

| Fig. | Index | PART NUMBER  | NOMENCLATURE                             | Units Per<br>Assem. |
|------|-------|--------------|--|---------------------|
| 16   |       | 414-189131   | Duct Installation - Carburetor<br>Air    | 1                   |
|      |       | 414-189131-3 | Elbow Assembly - Carburetor<br>Air Scoop | 1                   |
|      |       | 414-189131-4 | Elbow Assembly - Carburetor<br>Air Scoop | 1                   |

Fig. 17 Lower Wrapper Sheets

| Fig. | Index | PART NUMBER  | NOMENCLATURE   | Units Per Assem. |
|------|-------|--------------|--|------------------|
| 17   |       | 414-185850   | Sheet Assembly - Wrapper<br>Engine Accessory Section | 1                |
|      |       | 414-185850-1 | Sheet Assembly - Wrapper<br>LH                       | 1                |
|      |       | 414-185850-2 | Sheet Assembly - Wrapper<br>RH                       | 1                |
|      |       | 414-185850-3 | Sheet Assembly - Wrapper<br>LH                       | 1                |
|      |       | 414-185850-4 | Sheet Assembly - Wrapper<br>RH                       | 1                |

## Upper Cowling Assembly

| Fig. | Index | PART NUMBER   | NOMENCLATURE                       | Units Per<br>Assem. |
|------|-------|---------------|------------------------------------|---------------------|
| 18   |       | 414-185901    | Cowling Assembly - Engine<br>Upper | 2                   |
|      |       | 414-185901-13 | Ramp - Engine Upper Cowl           | 1                   |
|      |       | 414-185901-11 | Side - Engine Upper Cowl LH        | 1                   |
|      |       | 414-185901-12 | Side - Engine Upper Cowl RH        | 1                   |
|      |       | 414-185901-15 | Clip - Engine Upper Cowl           | 4                   |

Fig. 19 Lower Cowling Assembly

| Fig. | Index | PART NUMBER   | NOMENCLATURE                    | Units Per Assem. |
|------|-------|---------------|---------------------------------|------------------|
| 19   |       | 414-185903    | Cowling Assembly - Engine Lower | 1                |
|      |       | 414-185903-9  | Cover - Engine Lower Cowling    | 1                |
|      |       | 114330-006-08 | Seal - Engine Lower Cowling     | 2                |

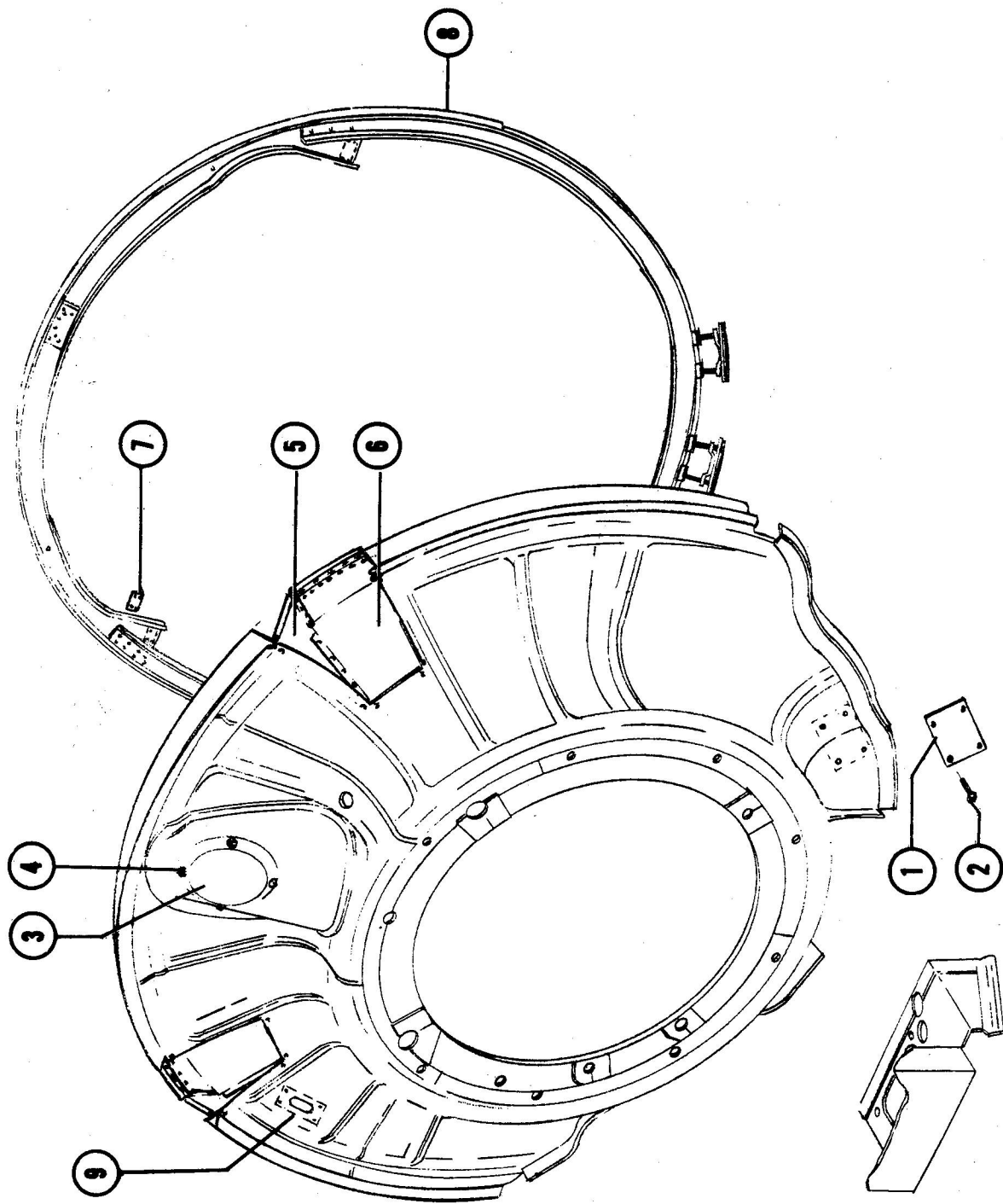

Fig. 20 Inner Cowl and Former Ring Assembly



Fig. 20 Inner Cowl and Former Ring Assembly

| Fig. | Index | PART NUMBER   | NOMENCLATURE                 | Units Per Assem. |
|------|-------|---------------|------------------------------|------------------|
| 20   |       | 414-185911    | Cowl Assembly - Engine Inner | 2                |
|      | 1     | 694-185910-40 | Plate - Engine Inner Cowl    | 1                |
|      | 2     | AN515-8R8     | Screw                        | 4                |
|      |       | AN960-10      | Washer                       | 4                |
|      | 3     | AN365-832     | Nut                          | 4                |
|      |       | 84-185910-28  | Cover - Engine Inner Cowl    | 1                |
|      | 4     | AN515-8-6     | Screw                        | 4                |
|      |       | 414-185940    | Ring - Cowl Support Former   | 1                |
|      | 5     | 414-185911-29 | Duct - Side LH               | 1                |
|      |       | 414-185911-30 | Duct - Side RH               | 1                |
|      | 6     | 414-185911-27 | Duct - Bottom                | 1                |
|      |       | 185941        | Bracket - Inner Cowl Support | 1                |
|      | 8     | 414-185940-13 | Bumper - Engine Inner Cowl   | 1                |
|      |       | 414-185911-31 | Strip                        | 4                |
|      | 9     | 414-185911-35 | Strip                        | 2                |
|      |       | 414-185911-57 | Cover - Generator Blast      | 1                |
|      |       |               | Tube                         |                  |

Fig. 21 Firewall Assembly LH

| Fig. | Index | PART NUMBER   | NOMENCLATURE                           | Units Per Assem. |
|------|-------|---------------|--|------------------|
| 21   |       | 414-189300-1  | Firewall Installation LH               | 1                |
|      |       | 414-189502-1  | Firewall Assembly LH                   | 1                |
|      |       | 414-189500    | Parts Installation - Standard Firewall | 1                |
|      |       | 414-189500-13 | Patch                                  | 1                |
|      |       | 414-189500-7  | Rim                                    | 1                |
|      |       | 414-189500-5  | Rim                                    | 1                |
|      |       | 414-189500-3  | Rim                                    | 1                |

Fig. 22 Firewall Assembly RH

| Fig. | Index | PART NUMBER   | NOMENCLATURE                           | Units Per Assem. |
|------|-------|---------------|--|------------------|
| 22   |       | 414-189300-2  | Firewall Installation RH               | 1                |
|      |       | 414-189502-2  | Firewall Assembly RH                   | 1                |
|      |       | 414-189500    | Parts Installation - Standard Firewall | 1                |
|      |       | 414-189500-13 | Patch                                  | 1                |
|      |       | 414-189500-8  | Rim                                    | 1                |
|      |       | 414-189500-6  | Rim                                    | 1                |
|      |       | 414-189500-4  | Rim                                    | 1                |

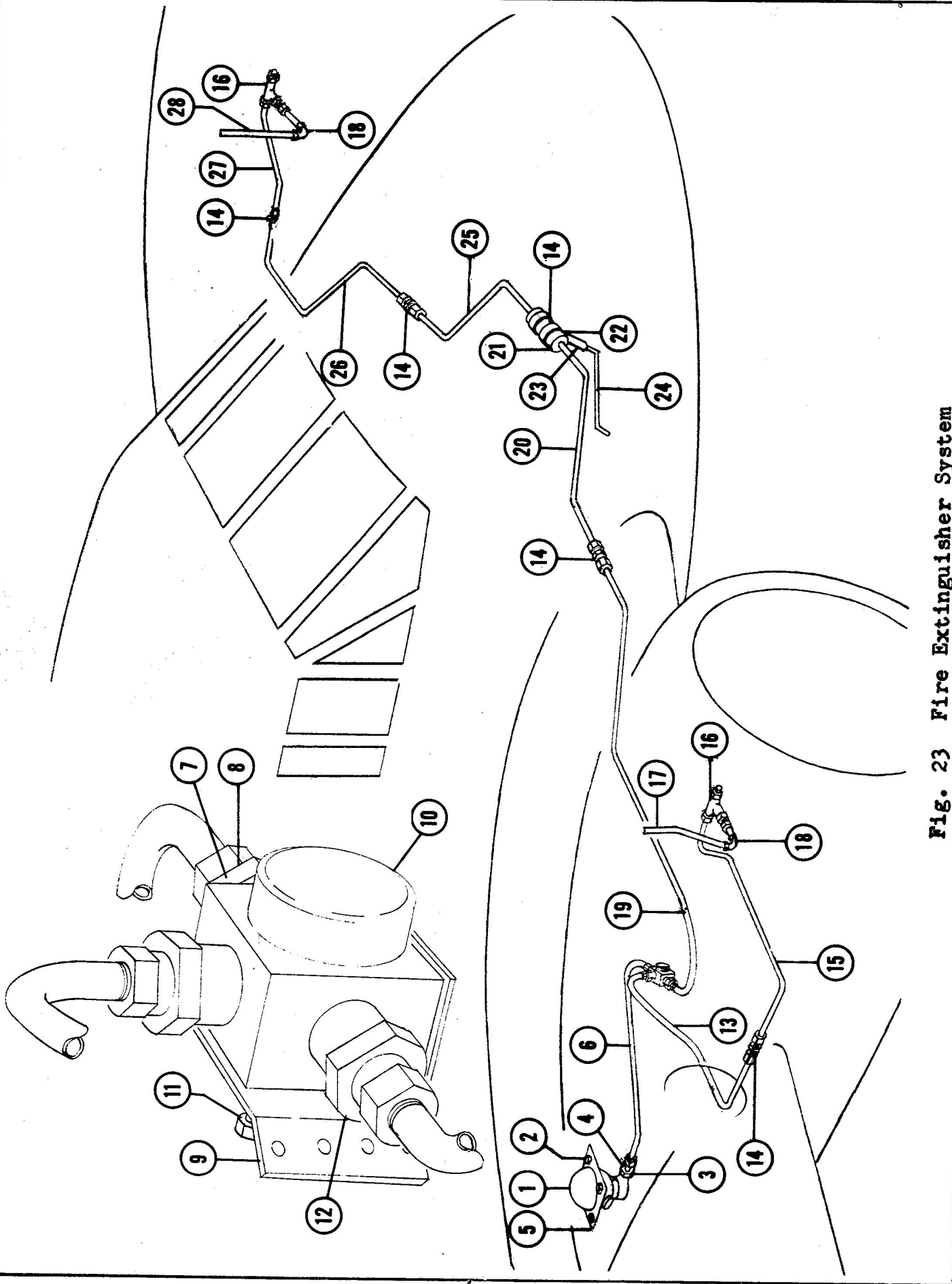

Fig. 23 Fire Extinguisher System

Fig. 23 Fire Extinguisher System

| Fig. | Index | PART NUMBER   | NOMENCLATURE  | Units Per Assem. |
|------|-------|---------------|---|------------------|
| 23   |       | 414-183187    | Extinguisher Installation -   |                  |
|      |       |               | CB Fire   | 1                |
|      | 1     | 870271        | Sphere - CB Fire Extinguisher<br>(Walter Kidde & Co. Inc.)  | 1                |
|      |       | 2CD-6440      | Sphere - CB Fire Extinguisher<br>(American Lafrance Foamite<br>Corporation) Alternate<br>for 870271 | 1                |
|      | 2     | AN5-5A        | Bolt  | 4                |
|      | 3     | AN902B-20     | Gasket  | 1                |
|      | 4     | AN919-25D     | Adapter   | 1                |
|      | 5     | 694-183131    | Bracket - Fire Extinguisher<br>Sphere Mounting  | 1                |
|      | 6     | 414-183187-7  | Tube Assembly - Fire<br>Extinguisher  | 1                |
|      | 7     | AN919-23D     | Adapter   | 1                |
|      | 8     | AN902B-16     | Gasket  | 2                |
|      | 9     | 414-183187-3  | Bracket - Directional Valve   | 1                |
|      | 10    | 870937        | Valve - Fire Extinguisher<br>Directional (Walter Kidde<br>Co. Inc.)                                 | 1                |
|      | 11    | AN4-B4A       | Bolt  | 2                |
|      | 12    | AN919-22D     | Adapter   | 1                |
|      | 13    | 414-183187-11 | Tube Assembly - Fire Ex-<br>tinguisher  | 1                |
|      | 14    | AN815-10D     | Union   | 5                |
|      | 15    | 404-183182-5  | Tube Assembly - Fire Ex-<br>tinguisher  | 1                |
|      | 16    | AN804-10D     | Tee   | 2                |
|      | 17    | 694-183170    | Tube Assembly - Fire Ex-<br>tinguisher  | 1                |
|      | 18    | AN837-8D      | Elbow   | 2                |
|      | 19    | 414-183187-15 | Tube Assembly - Fire Ex-<br>tinguisher  | 1                |
|      | 20    | 404-183182-17 | Tube Assembly - Fire Ex-<br>tinguisher  | 1                |
|      | 21    | 404-183183    | Shell Half - Evaporator Trap  | 1                |
|      | 22    | 404-183188    | Shell Half - Evaporator Trap  | 1                |
|      | 23    | 106200H-4-15  | Hose  | 1                |
|      | 24    | 404-183177    | Tube Assembly - Fire Ex-<br>tinguisher  | 1                |
|      | 25    | 404-183182-21 | Tube Assembly - Fire Ex-<br>tinguisher  | 1                |
|      | 26    | 404-183182-25 | Tube Assembly - Fire Ex-<br>tinguisher  | 1                |
|      | 27    | 404-183182-29 | Tube Assembly - Fire Ex-<br>tinguisher  | 1                |
|      | 28    | 694-183169    | Tube Assembly - Fire Ex-<br>tinguisher  | 1                |

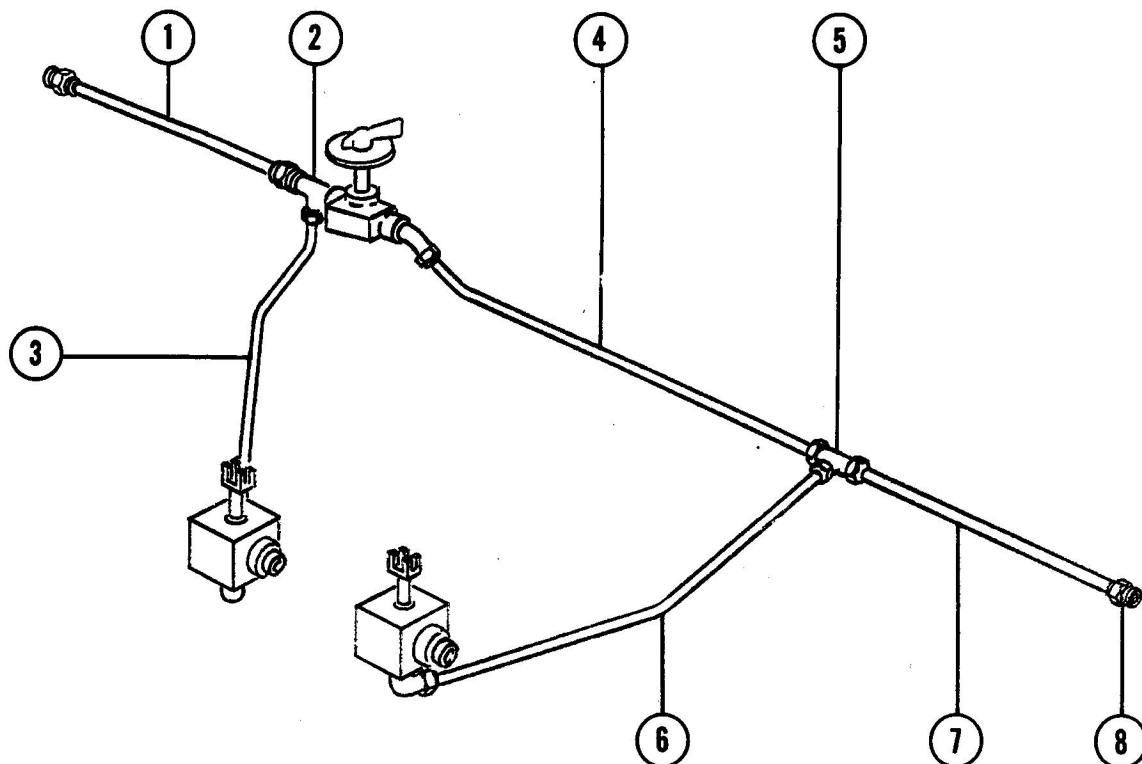

Fig. 24 Fuel System

| Fig. | Index | PART NUMBER  | NOMENCLATURE                | Units Per Assem. |
|------|-------|--------------|-----------------------------|------------------|
| 24   |       | 414-189707   | Fuel System Installation    | 1                |
|      | 1     | 414-189707-1 | Tube Assembly - Fuel System | 1                |
|      | 2     | AN826-10D    | Tee                         | 1                |
|      | 3     | 414-189707-3 | Tube Assembly - Fuel System | 1                |
|      | 4     | 414-189707-5 | Tube Assembly - Fuel System | 1                |
|      | 5     | AN824-10D    | Tee                         | 1                |
|      | 6     | 414-189707-7 | Tube Assembly - Fuel System | 1                |
|      | 7     | 414-189707-9 | Tube Assembly - Fuel System | 1                |
|      | 8     | AN832-10D    | Union - Bulkhead            | 2                |

## Fig. 25 Engine Controls System

| Fig. | Index | PART NUMBER  | NOMENCLATURE                              | Units Per<br>Assem. |
|------|-------|--------------|---|---------------------|
| 25   |       | 414-189058   | Control Installation -<br>Engine          | 1                   |
|      |       | 414-189534-1 | Bracket - Cowl Flap Control<br>Support LH | 1                   |
|      |       | 414-189534-2 | Bracket - Cowl Flap Control<br>Support RH | 1                   |
|      |       | 414-189038-2 | Control Assembly - Cowl Flap<br>LH        | 1                   |
|      |       | 414-189038-4 | Control Assembly - Cowl Flap<br>RH        | 1                   |

Fig. 26 Control Pedestal Assembly

| Fig. | Index | PART NUMBER | NOMENCLATURE                  | Units Per Assem. |
|------|-------|-------------|-------------------------------|------------------|
| 26   |       | 414-189055  | Control Installation Pedestal | 1                |
|      |       | 414-183860  | Control Assembly - Pedestal   | 1                |
|      |       | 414-189691  | Placard - Pedestal Control    | 1                |



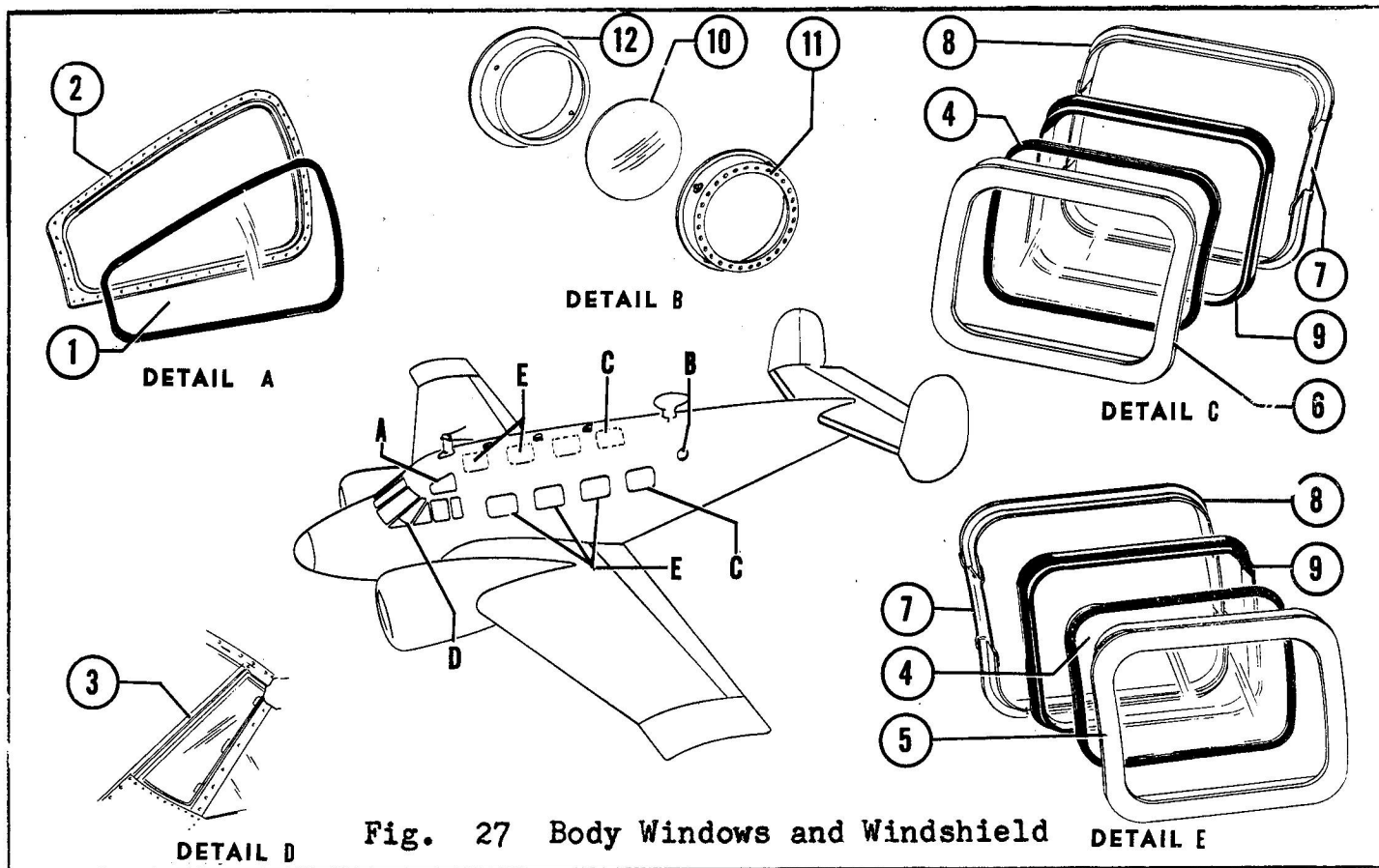

Fig. 27 Body Windows and Windshield

| Fig. | Index      | PART NUMBER                       | NOMENCLATURE                                  | Units Per Assem. |
|------|------------|-----------------------------------|---|------------------|
| 27   |            | 414-184000                        | Structure Assembly - Fuselage                 | 1                |
|      |            | 414-184002                        | Structure Assembly - Fuselage Cockpit Section | 1                |
|      | 1          | 414-184002-25                     | Pane - Pilots Upper Windows LH                | 1                |
|      |            | 414-184002-26                     | Panel- Pilots Upper Window RH                 | 1                |
|      | 2          | 414-184002-27                     | Frame - Pilots Upper Window LH                | 1                |
|      |            | 414-184002-28                     | Frame - Pilots Upper Window RH                | 1                |
|      | 3          | 414-185530-1                      | Window Assembly - Storm LH only               | 1                |
|      |            | 414-184003                        | Structure Assembly - Fuselage Cabin Section   | 1                |
|      | 4          | 414-184003-37                     | Pane - Cabin Window                           | 7                |
|      | 5          | 414-184003-29                     | Frame - Cabin Window Outer                    | 5                |
|      | 6          | 414-184003-31                     | Frame - Cabin Window Outer Rear LH            | 1                |
|      |            | 414-184003-32                     | Frame - Cabin Window Outer Rear RH            | 1                |
|      | 7          | 414-184003-25                     | Frame - Cabin Window Outer                    | 7                |
|      | 8          | 414-184003-27                     | Frame - Cabin Window Inner                    | 7                |
|      |            | 414-184003-28                     | Frame - Cabin Window Inner                    | 7                |
|      | 9          | 414-184003-35                     | Retainer - Cabin Window                       | 7                |
|      | 414-184004 | Structure Assembly - Fuselage Aft | 1   |                  |

| Fig. | Index | PART NUMBER   | NOMENCLATURE              | Units Per Assem. |
|------|-------|---------------|---------------------------|------------------|
| 27   | 10    | 414-184004-53 | Porthole Assembly - Cabin | 1                |
|      | 11    | 404-184458    | Glass - Porthole          | 1                |
|      | 12    | 184451        | Ring - Porthole           | 1                |
|      |       | 185601        | Moulding - Porthole       | 1                |

Fig. 28 Pilots Floorboards

| Fig. | Index | PART NUMBER  | NOMENCLATURE                                    | Units Per Assem. |
|------|-------|--------------|---|------------------|
| 28   |       | 414-183120   | Floorboard Installation -<br>Pilots Compartment | 1                |
|      |       | 414-183120-1 | Plate - Pilots Compartment<br>Floorboard        | 1                |
|      |       | 414-184137   | Board Assembly - Pilots<br>Compartment Floor LH | 1                |
|      |       | 414-184138   | Board Assembly - Pilots<br>Compartment Floor RH | 1                |

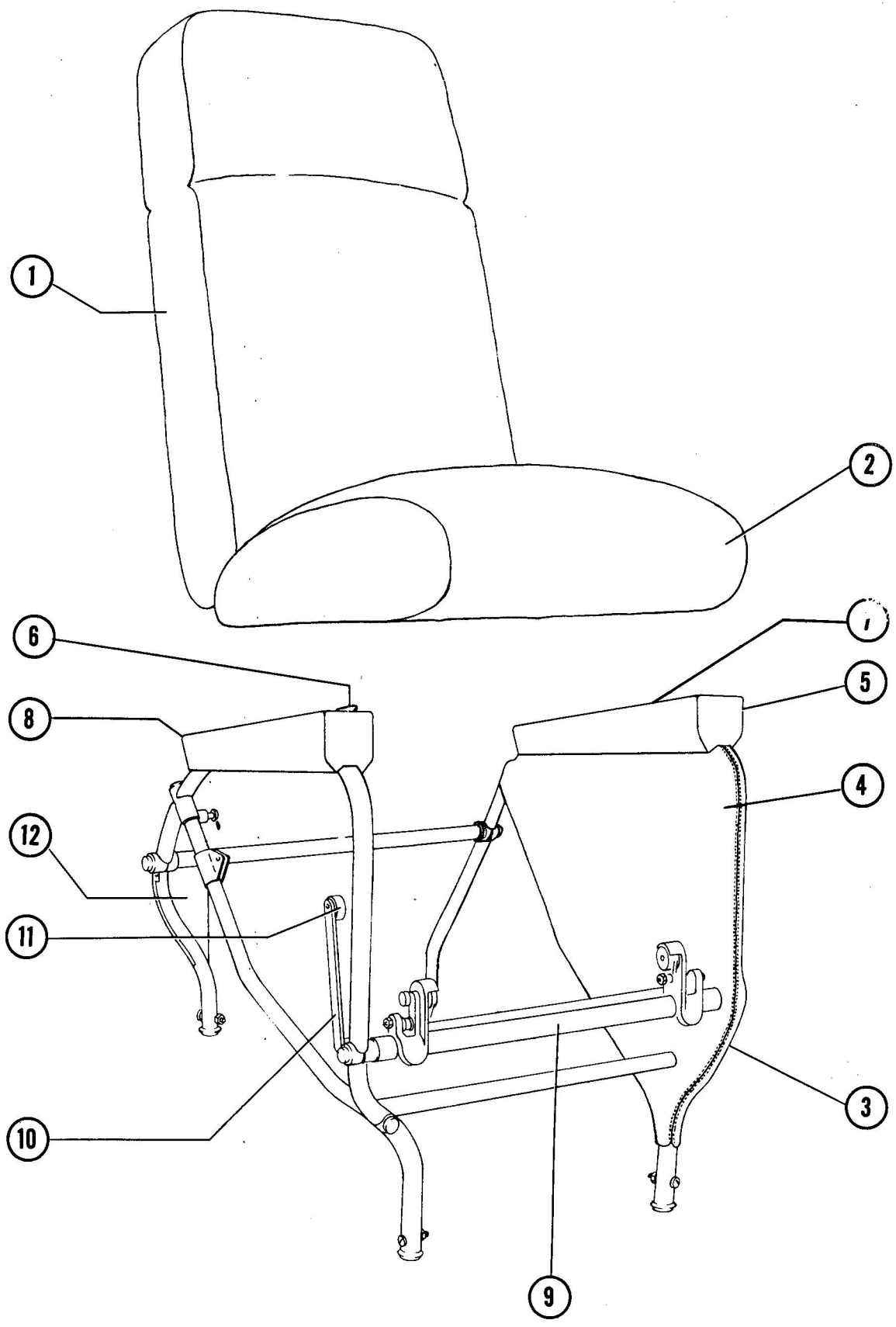

Fig. 29 Cabin Chair - Reclining

Fig. 29 Cabin Chair - Reclining

| Fig. | Index | PART NUMBER    | NOMENCLATURE  | Units Per Assem. |
|------|-------|----------------|---|------------------|
| 29   |       | 414-183393-1   | Chair Assembly - Cabin LH                           | AR               |
|      |       | 414-183393-2   | Chair Assembly - Cabin RH                           | AR               |
|      |       | 414-183393-4   | Chair Assembly - Cabin RH                           | AR               |
|      | 1     | 414-183393-19* | Back Assembly - Cabin Chair                         | 1                |
|      | 2     | 414-183393-15* | Seat Assembly - Cabin Chair                         | 1                |
|      |       | 404-180237-2   | Lug - Chair Attaching (-1 & -2 Assembly only)       | 4                |
|      |       | 404-180237-6   | Lug - Chair Attaching Front (-4 Assembly only)      | 2                |
|      |       | 404-180237-8   | Lug - Chair Attaching Rear (-4 Assembly only)       | 2                |
|      |       | 414-183393-17  | Base Assembly - Cabin Chair (-1 Assembly only)      | 1                |
|      |       | 414-183393-18  | Base Assembly - Cabin Chair (-2 & -4 Assembly only) | 1                |
|      | 3     | 414-183393-11* | Side - Upholstery LH (-17 Assembly only)            | 1                |
|      |       | 414-183393-12* | Side - Upholstery RH (-18 Assembly only)            | 1                |
|      | 4     | 414-183393-14* | Cover - Side Arm RH (-17 Assembly only)             | 1                |
|      |       | 414-183393-13* | Cover - Side Arm LH (-18 Assembly only)             | 1                |
|      | 5     | 414-183393-9*  | Upholstery - Arm Rest                               | 1                |
|      |       | 414-183393-10* | Upholstery - Arm Rest                               | 1                |
|      | 6     | 1-A-390        | Tray - Ash  | 1                |
|      |       | 414-183396-100 | Base Assembly - Cabin Chair (-17 Assembly only)     | 1                |
|      |       | 414-183396-101 | Base Assembly - Cabin Chair (-18 Assembly only)     | 1                |
|      | 7     | 414-183396-29  | Arm Assembly - Rest (-100 Assembly only)            | 1                |
|      | 8     | 414-183396-30  | Arm Assembly - Rest (-101 Assembly only)            | 1                |
|      | 9     | 414-183396-13  | Tube - Base Actuator                                | 1                |
|      | 10    | 414-183396-5   | Arm Assembly - Base Actuator                        | 1                |
|      | 11    | 414-183396-11  | Button - Base Actuator Arm                          | 1                |
|      | 12    | 414-183396-3   | Panel - Trim (-100 Assembly only)                   | 1                |
|      |       | 414-183396-4   | Panel - Trim (-101 Assembly only)                   | 1                |

\* When ordering replacement parts - Order by color and material Description.

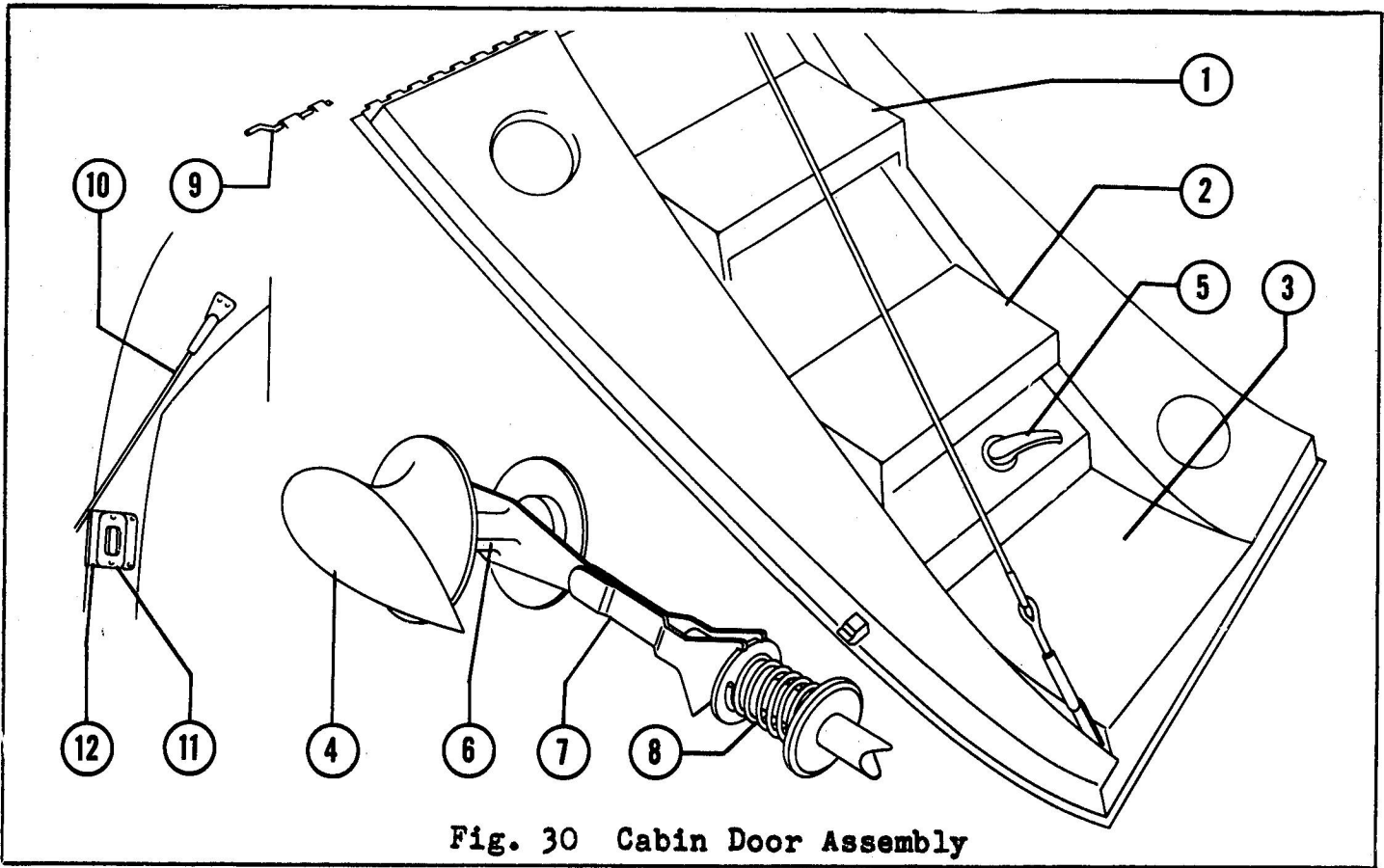

Fig. 30 Cabin Door Assembly

| Fig. | Index | PART NUMBER          | NOMENCLATURE                       | Units Per Assem. |
|------|-------|----------------------|------------------------------------|------------------|
| 30   |       | 414-185601           | Door Installation - Cabin          | 1                |
|      |       | 414-185600           | Door Assembly - Cabin              | 1                |
|      | 1     | 414-185600-23        | Step - Cabin Door Upper            | 1                |
|      | 2     | 414-185600-25        | Step - Cabin Door Center           | 1                |
|      | 3     | 414-185600-31        | Step - Cabin Door Lower            | 1                |
|      | 4     | 814-185639           | Handle Assembly - Cabin Door Outer | 1                |
|      | 5     | 414-185600-61        | Handle Assembly - Inner            | 1                |
|      | 6     | 414-185600-57        | Lever Assembly - Cabin Door Handle | 1                |
|      | 7     | 414-185600-53        | Yoke Assembly - Cabin Door Handle  | 1                |
|      | 8     | 100943-090-015-108-7 | Spring - Cabin Door Handle         | 2                |
|      | 9     | 414-185601-3         | Pin - Cabin Door Hinge             | 1                |
|      | 10    | 414-185601-15        | Cable Assembly - Cabin Door        | 1                |
|      | 11    | 414-185601-13        | Plate - Latch                      | 2                |
|      | 12    | 414-185601-11        | Reinforcement - Latch Plate        | 2                |

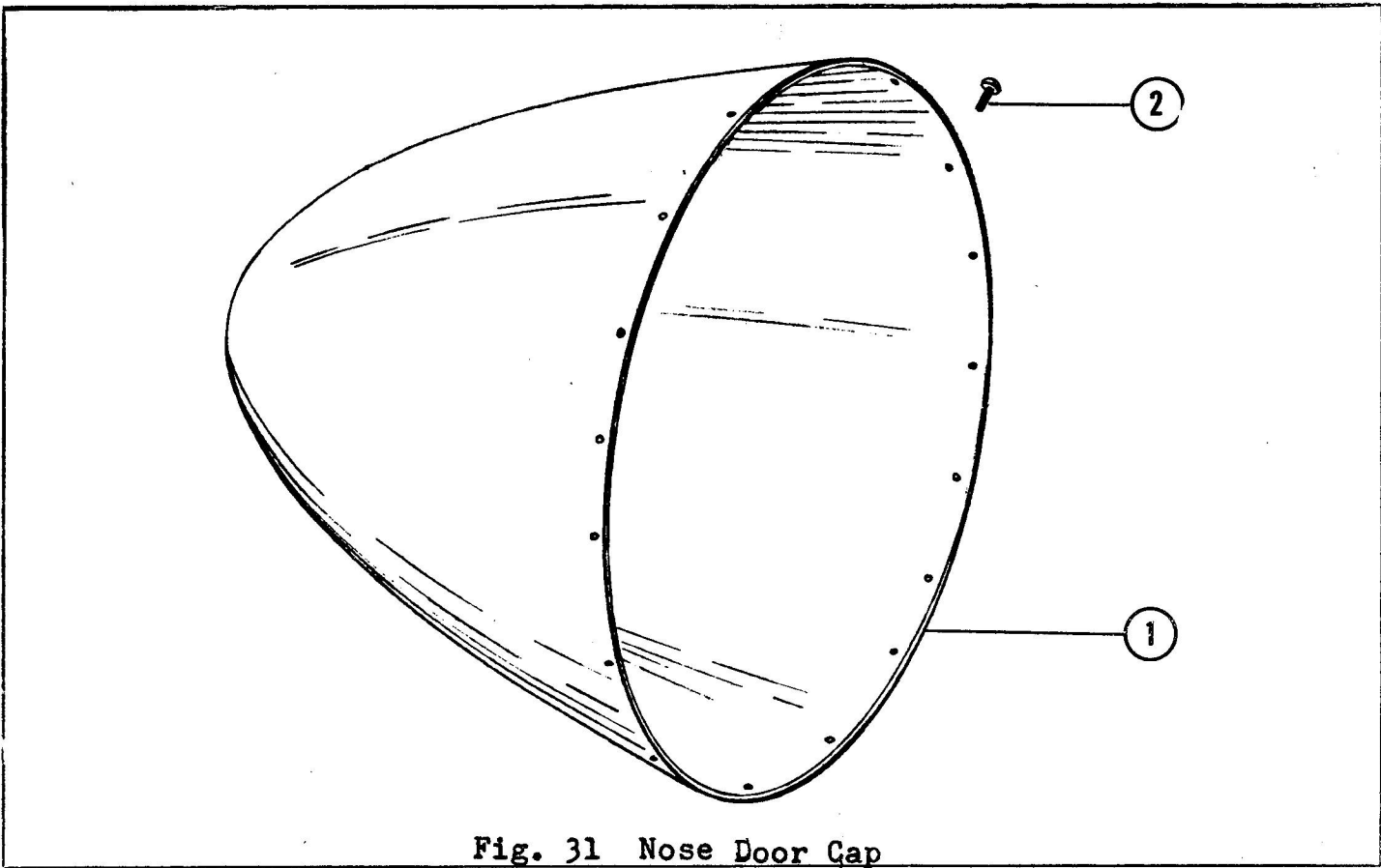

Fig. 31 Nose Door Cap

| Fig. | Index | PART NUMBER | NOMENCLATURE                  | Units Per Assem. |
|------|-------|-------------|-------------------------------|------------------|
| 31   |       | 414-184001  | Structure Assembly - Fuselage | Ref              |
|      | 1     | 414-185260  | Cap Assembly - Nose           | 1                |
|      | 2     | AN520-10R6  | Screw                         | 17               |

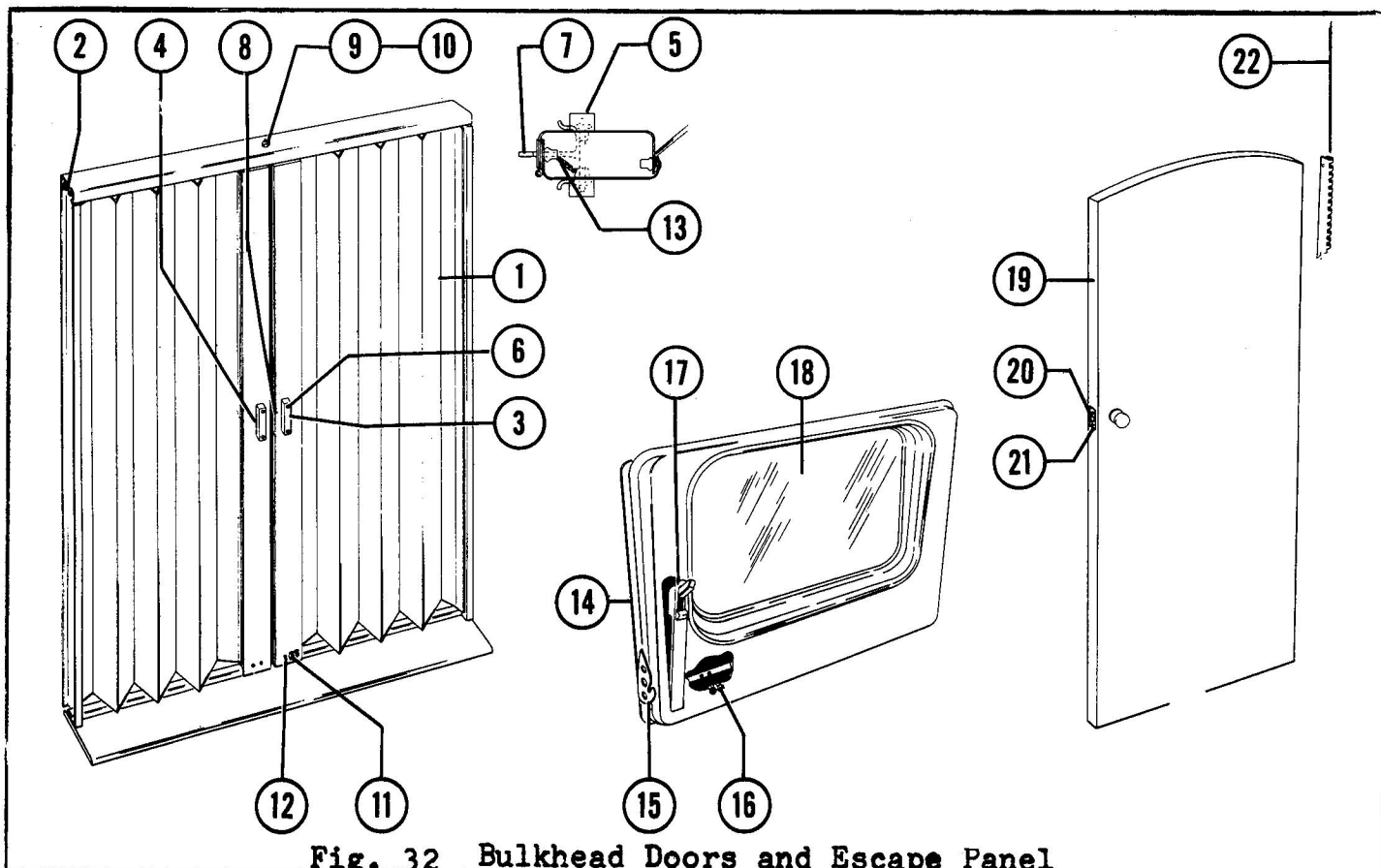

Fig. 32 Bulkhead Doors and Escape Panel

| Fig. | Index | PART NUMBER              | NOMENCLATURE                           | Units Per Assem. |
|------|-------|--------------------------|--|------------------|
| 32   |       |                          |  |                  |
|      | 1     | 414-184051               | Door Installation - #5 Bulkhead        | 1                |
|      |       | 414-184051-39            | Door Assembly - #5 Bulkhead LH         | 1                |
|      |       | 414-184051-40            | Door Assembly - #5 Bulkhead RH         | 1                |
|      | 2     | 414-184051-7             | Hanger Assembly - #5 Bulkhead Door     | 2                |
|      | 3     | 414-184051-27            | Pull - #5 Bulkhead Door LH             | 2                |
|      | 4     | 414-184051-29            | Pull - #5 Bulkhead Door Front RH       | 1                |
|      | 5     | 414-184051-30            | Pull - #5 Bulkhead Door Rear RH        | 1                |
|      | 6     | NAS387-632-10P           | Screw                                  | 7                |
|      |       | NAS387-632-18P           | Screw                                  | 1                |
|      | 7     | 414-184051-31            | Latch Assembly - #5 Bulkhead Door      | 1                |
|      | 8     | 414-184051-23            | Strike - #5 Bulkhead Door              | 2                |
|      | 9     | 414-184051-13            | Stop - #5 Bulkhead Door                | 1                |
|      | 10    | AN507-832-14             | Screw                                  | 1                |
|      | 11    | 414-184051-25            | Block - #5 Bulkhead Door Guide         | 2                |
|      | 12    | NAS387-832-14P           | Screw                                  | 4                |
|      | 13    | 100942-025-005<br>020-20 | Spring - #5 Bulkhead Door Latch Return | 1                |
|      | 14    | 414-185650               | Door Assembly - Emergency Exit         | 1                |
|      | 15    | 644-184456               | Cam Assembly - Emergency Exit LH       | 1                |
|      |       | 644-184456-1             | Cam Assembly - Emergency Exit RH       | 1                |
|      | 16    | NAS221-19                | Screw                                  | 4                |



| Fig. | Index | PART NUMBER     | NOMENCLATURE                              | Units Per Assem. |
|------|-------|-----------------|---|------------------|
| 32   | 17    | 414-185650-29   | Handle Assembly - Emergency Exit          | 1                |
|      | 18    | 414-184003-37   | Pane - Emergency Exit Window              | 1                |
|      |       | 414-184095      | Partition Installation - #9 Bulkhead      | 1                |
|      | 19    | 414-184095-1    | Door Assembly - #9 Bulkhead Partition     | 1                |
|      | 20    | 15156           | Latch Set - #9 Bulkhead Partition Door    | 1                |
|      | 21    | 414-184095-7    | Plate - #9 Bulkhead Partition Door Strike | 1                |
|      | 22    | 101816-05008-50 | Pin - #9 Bulkhead Partition Door Hinge    | 1                |

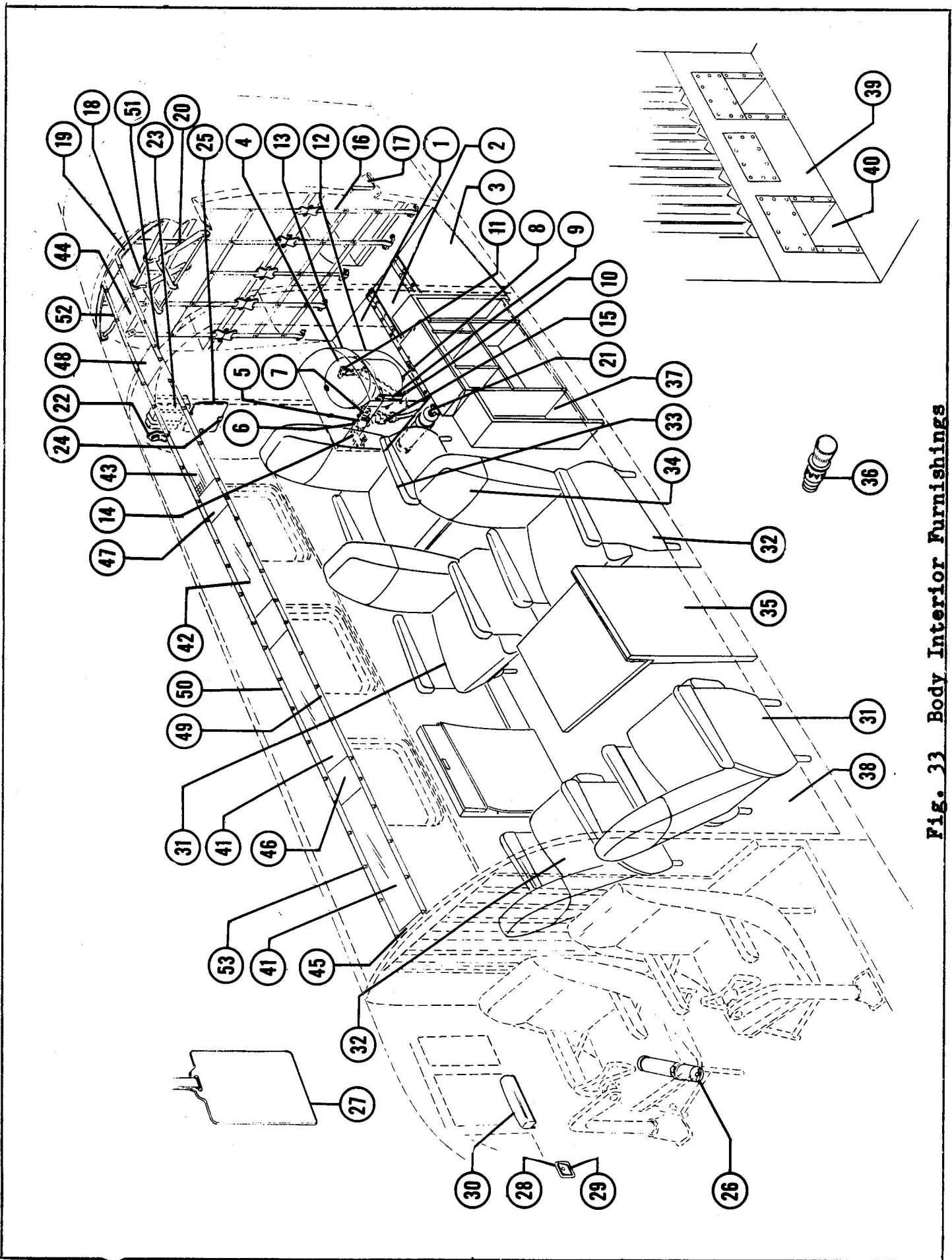

Fig. 33 Body Interior Furnishings

Fig. 33 Body Interior Furnishings

| Fig. | Index        | PART NUMBER                      | NOMENCLATURE                                      | Units Per Assem. |
|------|--------------|----------------------------------|---|------------------|
| 33   |              | 414-180640                       | Cabin Furnishings Installation                    | 1                |
|      |              | 414-183200                       | Lavatory Compartment Installation                 | 1                |
|      | 1            | 414-183150-17                    | Floorboard Assembly - Lavatory Compartment        | RH 1             |
|      | 2            | 414-183150-25                    | Floorboard Assembly - Lavatory Compartment Center | 1                |
|      | 3            | 414-183150-3                     | Floorboard Assembly - Lavatory Compartment        | LH 1             |
|      | 4            | 414-183200-49                    | Sanitary Toilet                                   | 1                |
|      | 5            | 414-183200-59                    | Flange Assembly - Toilet Vent                     | 1                |
|      | 6            | 181177                           | Cover - Toilet Vent                               | 1                |
|      | 7            | P-212                            | Hose - Toilet Vent                                | 1                |
|      | 8            | 414-183200-43                    | Base - Sanitary Toilet                            | 2                |
|      | 9            | 414-183200-51                    | Belt Assembly - Sanitary Toilet                   | 1                |
|      | 10           | #6411BNP                         | Footman Loop                                      | 12               |
|      | 11           | 414-183200-47                    | Hook - Belt                                       | 1                |
|      | 12           | 414-183200-19                    | Shell Assembly - Sanitary Toilet                  | 1                |
|      | 13           | 414-183200-1                     | Lid Assembly - Sanitary Toilet Shell              | 1                |
|      | 14           | #2609                            | Holder - Tissue                                   | 1                |
|      | 15           | 407-180632                       | Tube Assembly - Relief                            | 1                |
|      |              | 106043-S-12-08                   | Tube - Relief                                     | 1                |
|      |              | AN8018-1                         | Horn - Relief Tube                                | 1                |
|      |              | 41A9177                          | Venturi - Relief Tube                             | 1                |
|      |              | 180648P                          | Plate - Venturi                                   | 1                |
|      |              | NO NUMBER                        | Cloroben  | AR               |
|      |              | NO NUMBER                        | Sanitary Disposal Bags                            | 6                |
|      | 16           | 414-180644-1                     | Webbing Assembly                                  | 1                |
|      |              | 414-180644-3                     | Webbing Assembly                                  | 1                |
|      | 17           | AN8011-1A                        | Case - Data                                       | 1                |
|      |              | 111745                           | Placard - Model                                   | 1                |
|      | 18           | 414-180645-1                     | Beam Assembly - Coat Hanger                       | 1                |
|      | 19           | 414-180645-3                     | Plate - Coat Hanger Beam Trim                     | 1                |
|      | 20           | 35-590058                        | Hanger - Coat                                     | 2                |
|      | 21           | Type A-2                         | Extinguisher - Fire                               | 1                |
|      | 22           | NO NUMBER                        | Holder - Denning Hat                              | 1                |
|      | 23           | FA12725                          | Kit - First Aid                                   | 1                |
|      | 24           | 414-180640-5                     | Retainer - Mirror                                 | 4                |
| 25   | 414-180640-3 | Mirror                           | 1   |                  |
| 26   | 900-180556   | Extinguisher - Fire              | 1   |                  |
| 27   | 39D3922      | Holder Assembly - Check List     | 1   |                  |
| 28   | 404-183731   | Plate - Ash Tray                 | 2   |                  |
| 29   | L1148        | Tray - Ash                       | 2   |                  |
| 30   | 404-183039   | Arm Rest Assembly                | 2   |                  |
| 31   | 414-183393-2 | Chair Assembly - Cabin           | 2   |                  |
| 32   | 414-183393-1 | Chair Assembly - Cabin           | 2   |                  |
| 33   | 414-183393-4 | Chair Assembly - Cabin           | 1   |                  |
| 34   | 414-180259   | Protector Assembly - Cabin Chair | 5   |                  |

| Fig. | Index | PART NUMBER    | NOMENCLATURE                             | Units Per Assem. |
|------|-------|----------------|--|------------------|
| 33   | 35    | 414-180291-1   | Table Assembly - Cabin LH                | 1                |
|      |       | 414-180291-2   | Table Assembly - Cabin RH                | 1                |
|      | 36    | L-131(12V)     | Lighter - Cigarette                      | 1                |
|      | 37    | 414-180296     | Cabinet - Refreshment                    | 1                |
|      | 38    | 414-180204-7   | Floorboard Assembly - Cabin LH           | 1                |
|      |       | 414-180205-11  | Floorboard Assembly - Cabin RH           | 1                |
|      |       | 404-183108     | Floorboard Assembly - Cabih Front Center | 1                |
|      |       | 404-183109     | Floorboard Assembly - Cabin Rear Center  | 1                |
|      | 39    | 404-183000-28  | Carpet - Footwell                        | 2                |
|      | 40    | 404-183000-26  | Panel - Forward Kick                     | 1                |
|      | 41    | 414-183000-79  | Glass - Forward Cabin Light              | 1                |
|      |       |                | Diffuser                                 | 2                |
|      | 42    | 414-183000-81  | Glass - Aft Cabin Light                  | 1                |
|      |       |                | Diffuser                                 | 1                |
|      | 43    | 414-183000-85  | Screen - Cabin Air                       | 1                |
|      | 44    | 414-183000-83  | Glass - Rear Cabin Light                 | 1                |
|      |       |                | Diffuser                                 | 1                |
|      | 45    | 414-183000-87  | Cover - Cabin Light                      | 1                |
|      | 46    | 414-183000-89  | Cover - Cabin Light                      | 2                |
|      | 47    | 414-183000-91  | Cover - Cabin Light                      | 1                |
|      | 48    | 414-183000-93  | Cover - Lavatory Compartment             | 2                |
|      |       |                | Light                                    | 1                |
|      | 49    | 414-183000-97  | Trim - Cabin Light LH                    | 1                |
|      | 50    | 414-183000-98  | Trim - Cabin Light RH                    | 1                |
|      | 51    | 414-183000-99  | Trim - Lavatory Compartment              | 1                |
|      |       |                | Light                                    | 1                |
|      | 52    | 414-183000-100 | Trim - Lavatory Compartment Light        | 1                |
|      | 53    | NAS384-6-8P    | Screw - Trim                             | AR               |

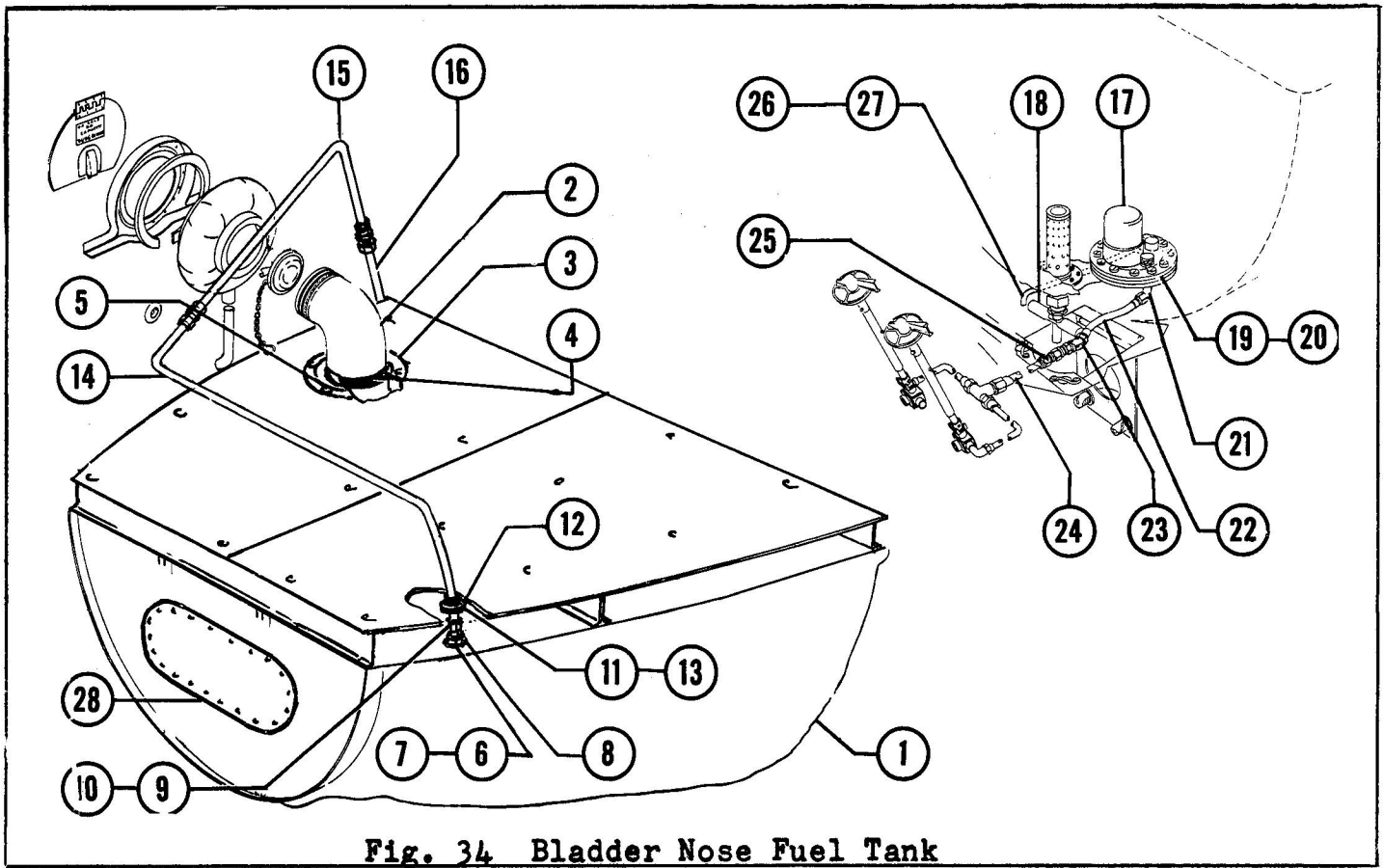

Fig. 34 Bladder Nose Fuel Tank

| Fig. | Index | PART NUMBER   | NOMENCLATURE                          | Units Per Assem. |
|------|-------|---------------|---------------------------------------|------------------|
| 34   |       | 414-189620    | Cell Installation - Nose Fuel         | 1                |
|      | 1     | 414-189621    | Cell Assembly - Nose Fuel             | 1                |
|      | 2     | 414-189620-7  | Neck Assembly - Nose Fuel Cell Filler | 1                |
|      | 3     | 414-189620-9  | Ring - Filler Neck                    | 1                |
|      | 4     | 414-189622    | Seal - Filler Neck                    | 1                |
|      | 5     | AN520R-10-8   | Screw - Filler Neck Ring Attaching    | 12               |
|      | 6     | 414-184412    | Fitting - Vent Tube                   | 1                |
|      | 7     | 414-184414    | Gasket - Vent Tube Fitting            | 1                |
|      | 8     | AN502-416-10  | Screw - Vent Tube Fitting Attaching   | 6                |
|      | 9     | AN815-8D      | Union - Vent Tube                     | 1                |
|      | 10    | MS29512-8     | Gasket - Vent Tube                    | 1                |
|      | 11    | 414-189620-29 | Cover - Vent Seal                     | 1                |
|      | 12    | AN520R10-8    | Screw - Cover Attaching               | 4                |
|      | 13    | 414-189623    | Seal - Vent Cover                     | 1                |
|      | 14    | 414-189620-31 | Tube Assembly - Vent                  | 1                |
|      | 15    | 414-189620-25 | Tube Assembly - Vent                  | 1                |
|      | 16    | 414-189620-17 | Tube Assembly - Vent                  | 1                |
|      | 17    | 28550         | Pump - Submerged Boost                | 1                |
|      | 18    | K-9000S-2A    | Cock-- Drain                          | 1                |
|      | 19    | FCB-25722     | Gasket - Submerged Boost Pump         | 1                |
|      | 20    | 694-189612    | Gasket - Submerged Boost Pump         | 1                |
|      | 21    | AN822-8D      | Elbow                                 | 1                |
|      | 22    | MS28741-8-070 | Hose Assembly - Fuel Pump             | 1                |

| Fig. | Index | PART NUMBER   | NOMENCLATURE              | Units Per Assem. |
|------|-------|---------------|---------------------------|------------------|
| 34   |       | AN924-8D      | Nut                       | 1                |
|      | 23    | AN837-8D      | Elbow                     | 1                |
|      | 24    | 414-189620-3  | Tube Assembly - Fuel Pump | 1                |
|      | 25    | AN894-10-8    | Bushing                   | 1                |
|      | 26    | 414-189620-11 | Tube Assembly - Pump Vent | 1                |
|      | 27    | AN822-4D      | Elbow                     | 1                |
|      | 28    | 414-189620-1  | Cover - Inspection        | 1                |

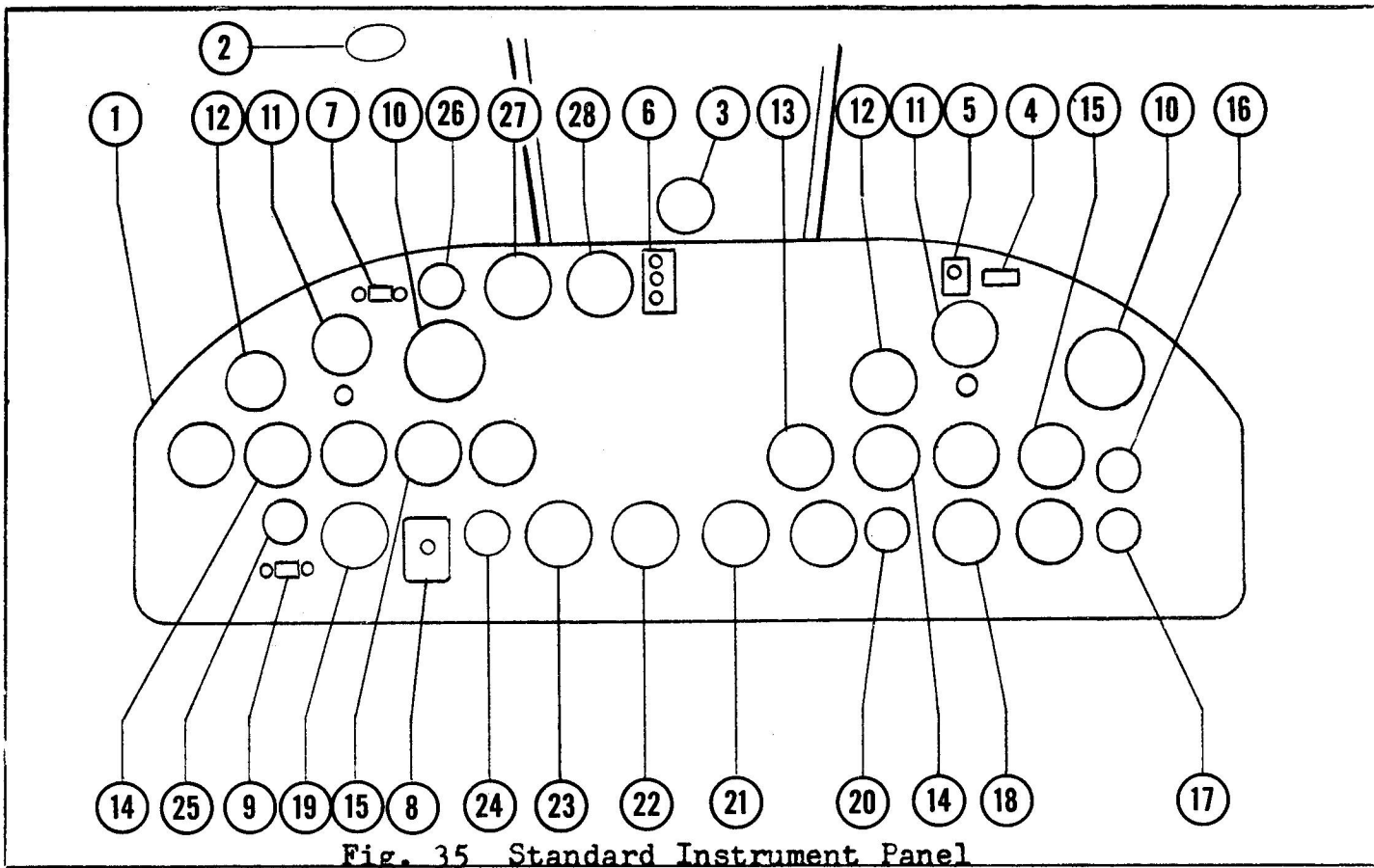

Fig. 35 Standard Instrument Panel

| Fig. | Index | PART NUMBER  | NOMENCLATURE  | Units Per Assem. |
|------|-------|--------------|---|------------------|
| 35   |       | 414-183761   | Panel Assembly - Floating                               | 1                |
|      | 1     | 414-183761-1 | Panel Assembly - Floating                               | 1                |
|      | 2     | 50-320116    | Indicator - Free Air Temperature<br>(Alter from C-13B)  | 1                |
|      | 3     | 414-180646   | Compass - Magnetic                                      | 1                |
|      | 4     | 901-183819   | Placard - Radio Call                                    | 1                |
|      | 5     | 414-180011   | Placard - Cabin Door Warning                            | 1                |
|      | 6     | 414-180045   | Placard - Marker Beacon                                 | 1                |
|      | 7     | 404-180051   | Placard - Fuel Warning                                  | 1                |
|      | 8     | 407-180026   | Placard - Fuel Selector                                 | 1                |
|      | 9     | 414-180014   | Placard - Vacuum Pump                                   | 1                |
|      | 10    | 656768       | Indicator - Gyro Horizon<br>(Sperry Gyroscope Co)       | 2                |
|      | 11    | 649742       | Indicator - Directional Gyro<br>(Sperry - Gyroscope Co) | 2                |
|      | 12    | 414-183735   | Indicator - Airspeed                                    | 2                |
|      | 13    | 6007         | Meter - Fuel Flow (Bendix-<br>Pioneer)                  | 1                |
|      | 14    | 50-320226-3  | Altimeter   | 2                |
|      | 15    | 50-320114    | Indicator - Rate of Climb                               | 2                |
|      | 16    | 414-183795   | Indicator - Deicer Pressure                             | 1                |
|      | 17    | 414-183759   | Indicator - Flap  | 1                |
|      | 18    | 50-320111    | Indicator - Turn and Bank                               | 1                |
|      | 19    | 414-183738   | Indicator - Turn and Bank                               | 1                |
|      | 20    | 414-183758   | Indicator - Elevator Tab                                | 1                |

| Fig. | Index | PART NUMBER | NOMENCLATURE                              | Units Per Assem. |
|------|-------|-------------|---|------------------|
| 35   | 21    | 414-183743  | Gage - Engine                             | 2                |
|      | 22    | 414-183736  | Indicator - Cylinder Head<br>Temperature  | 1                |
|      | 23    | 414-183737  | Indicator - Carburetor Air<br>Temperature | 1                |
|      | 24    | 414-183734  | Gage - Fuel                               | 1                |
|      | 25    | 50-320106   | Gage - Suction                            | 1                |
|      | 26    | AN5743-2    | Clock                                     | 1                |
|      | 27    | 414-183742  | Gage - Manifold Pressure                  | 1                |
|      | 28    | 414-183741  | Indicator - Tachometer                    | 1                |



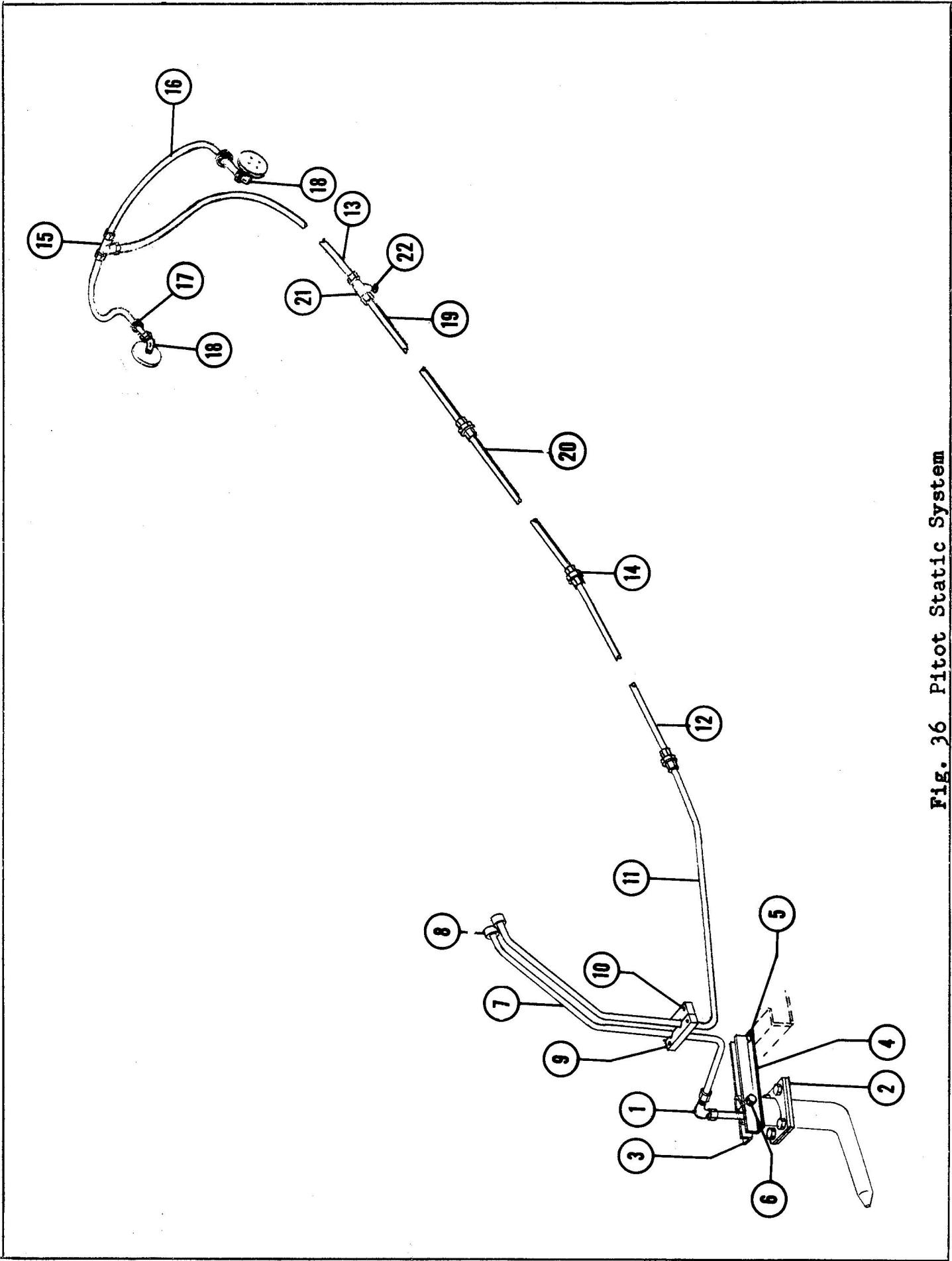

Fig. 36 Pitot Static System

Fig. 36 Pitot Static System

| Fig. | Index | PART NUMBER   | NOMENCLATURE                                   | Units Per Assem. |
|------|-------|---------------|--|------------------|
| 36   |       | 414-184720    | Lines Installation - Pitot and Static Pressure |                  |
|      | 1     | AN821-4D      | Elbow  | 1                |
|      | 2     | 804-184734    | Packing - Pitot Mast                           | 1                |
|      | 3     | 404-184719    | Support - Pitot Mast                           | 1                |
|      | 4     | 404-184718    | Support - Pitot Mast                           | 1                |
|      | 5     | AN526-832-7   | Screw  | 4                |
|      |       | AN960-8       | Washer   | 4                |
|      |       | AN365-832     | Nut  | 4                |
|      | 6     | 105982-3A-13  |  |                  |
|      |       | 012           | Bolt   | 1                |
|      |       | AN960-10      | Washer   | 1                |
|      |       | AN365-1032    | Nut  | 1                |
|      | 7     | 414-184720-15 | Tube Assembly - Pitot Mast                     | 1                |
|      | 8     | AN833-4D      | Fitting - Bulkhead                             | 2                |
|      |       | AN924-4D      | Nut  | 2                |
|      | 9     | 784-184740    | Plate - Pressure Line Support                  | 1                |
|      | 10    | AN526-832-16  | Screw  | 4                |
|      | 11    | 414-184720-11 | Tube Assembly - Static Pressure                | 1                |
|      | 12    | 404-184752    | Tube Assembly - Static Pressure                | 1                |
|      | 13    | 404-184720-3  | Tube Assembly - Static Pressure                | 1                |
|      | 14    | AN815-4D      | Union  | 6                |
|      | 15    | AN824-4D      | Tee  | 1                |
|      | 16    | 404-184720-7  | Tube Assembly - Static Pressure                | 2                |
|      | 17    | AN931-4-12    | Grommet  | 2                |
|      | 18    | AN822         | Elbow - Static Air Intake Port                 | 2                |
|      | 19    | 694-184743    | Tube Assembly - Static Pressure                | 1                |
|      | 20    | 414-184720-31 | Tube Assembly - Static Pressure                | 1                |
|      | 21    | AN825-4D      | Tee  | 1                |
|      | 22    | AN770-A1      | Drain  | 1                |
|      |       | AN910-1D      | Coupling                                       | 1                |
|      |       | 414-180047    | Placard  | 1                |

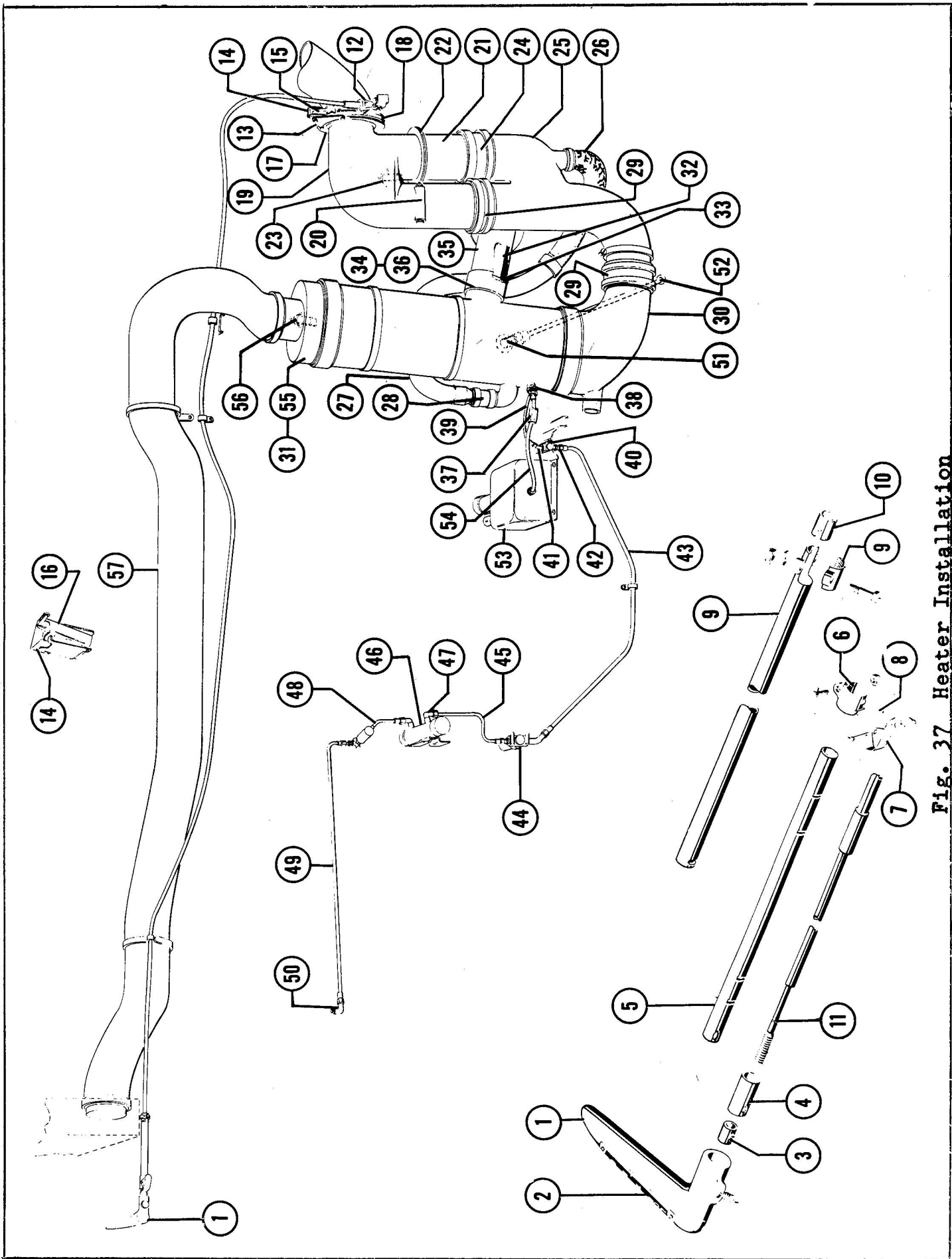

Fig. 37 Heater Installation

Fig. 37 Heater Installation

| Fig. | Index | PART NUMBER      | NOMENCLATURE                     | Units Per Assem. |
|------|-------|------------------|----------------------------------|------------------|
| 37   |       | 414-183950       | Heater Installation              | 1                |
|      |       | 414-183938       | Control Assembly - Heater        | 1                |
|      | 1     | 183092           | Handle - Heater Control          | 1                |
|      | 2     | 414-180060       | Placard - Heater Control         | 1                |
|      | 3     | 183091           | Collar - Heater Control          | 1                |
|      | 4     | 183076           | Collar - Heater Control          | 1                |
|      | 5     | 183078           | Plunger - Heater Control         | 1                |
|      | 6     | 183084           | Clamp Assembly - Heater Control  | 1                |
|      | 7     | 183077           | Latch - Heater Control           | 1                |
|      | 8     | 100943-040-008   |                                  |                  |
|      |       | 024-8S           | Spring - Heater Control          | 1                |
|      | 9     | 105019           | Clamp Assembly - Heater Control  | 1                |
|      | 10    | 183072           | Spacer - Heater Control          | 1                |
|      | 11    | 414-183939       | Control - Heater                 | 1                |
|      | 12    | AN486-4          | Clevis - Heater Control          | 1                |
|      | 13    | 414-183950-57    | Bracket - Heater Switch          | 1                |
|      | 14    | AN3210-1         | Switch - Heater                  | 2                |
|      | 15    | 9-10831          | Actuator - Heater Switch         | 1                |
|      | 16    | AN3169-1         | Actuator - Heater Switch         | 1                |
|      |       | 414-183963       | Duct Installation - Cabin Heater |                  |
|      |       |                  | Entrance Air                     | 1                |
|      | 17    | 1V-40-550        | Iris Valve - Cabin Heater        |                  |
|      |       |                  | Entrance Air Duct                | 1                |
|      | 18    | 414-183963-7     | Gasket - Cabin Heater Entrance   |                  |
|      |       |                  | Air Duct                         | 2                |
|      |       | 414-183963-1     | Duct Assembly - Cabin Heater     |                  |
|      |       |                  | Entrance Air                     | 1                |
|      | 19    | 414-183963-3     | Duct - Cabin Heater Entrance     |                  |
|      |       |                  | Air                              | 1                |
|      | 20    | 414-183963-5     | Valve - Cabin Heater Entrance    |                  |
|      |       |                  | Air Duct                         | 1                |
|      | 21    | M4861H-9A        | Blower - Cabin Heater Entrance   |                  |
|      |       |                  | Air Duct                         | 1                |
|      | 22    | 414-183963-9     | Gasket - Heater Blower           | 1                |
|      | 23    | 112447-B-RC-C-65 | Thermostat - Cabin Heater        |                  |
|      |       |                  | Entrance Air Duct                | 1                |
|      | 24    | 114632-41-10     | Hose - Heater Duct               | 3                |
|      | 25    | 414-183964       | Duct - Heater                    | 1                |
|      | 26    | P-5129 x 2       |                                  |                  |
|      |       | x 12             | Duct - Heater                    | 1                |
|      | 27    | 414-183950-43    | Tube Assembly - Heater           | 1                |
|      | 28    | 114632-12-10     | Hose - Heater Tube               | 1                |
|      | 29    | 114632-41-10     | Hose - Heater Duct               | 2                |
|      | 30    | 414-183962       | Plenum - Heater                  | 1                |
|      | 31    | F93A22           | Heater                           | 1                |
|      |       | 414-183961       | Exhaust Installation - Heater    | 1                |
|      | 32    | 414-183966       | Exhaust Assembly - Heater        | 1                |
|      | 33    | 414-183961-21    | Clamp - Exhaust                  | 1                |
|      | 34    | 414-183961-23    | Gasket - Exhaust Shroud          | 1                |
|      | 35    | 414-183961-1     | Shroud Assembly - Heater         |                  |
|      |       |                  | Exhaust                          | 1                |

| Fig. | Index               | PART NUMBER                      | NOMENCLATURE                           | Units Per Assem. |
|------|---------------------|----------------------------------|--|------------------|
| 37   | 36                  | 414-183961-9                     | Clamp - Exhaust Shroud                 | 1                |
|      | 37                  | 106242-13-00600                  | Tubing - Heater Ignition Cable Housing | 1                |
|      | 38                  | 105798-4                         | Clamp - Heater Ignition Cable Housing  | 1                |
|      | 39                  | 414-183950-23                    | Tube Assembly - Heater Fuel            | 1                |
|      | 40                  | 12257-24                         | Valve - Heater Fuel Shutoff            | 2                |
|      | 41                  | AN823-4D                         | Elbow - Heater Fuel Line               | 2                |
|      | 42                  | AN816-4D                         | Nipple - Heater Fuel                   | 4                |
|      | 43                  | 414-183950-15                    | Tube Assembly - Heater Fuel            | 1                |
|      | 44                  | 26450                            | Filter - Heater Fuel                   | 1                |
|      | 45                  | 414-183950-11                    | Tube Assembly - Heater Fuel            | 1                |
|      | 46                  | 476439                           | Pump - Heater Fuel                     | 1                |
|      | 47                  | AN822-4D                         | Elbow - Heater Fuel Pump               | 2                |
|      | 48                  | 414-183950-7                     | Tube Assembly - Heater Fuel            | 1                |
|      | 49                  | 414-183950-3                     | Tube Assembly - Heater Fuel            | 1                |
|      | 50                  | AN822-4D                         | Elbow - Heater Fuel                    | 1                |
|      | 51                  | AN822-6-2                        | Elbow - Heater Drain                   | 1                |
|      | 52                  | 414-183950-17                    | Tube Assembly - Heater Drain           | 1                |
| 53   | A55A00              | Ignition - Heater Unit           | 1                                      |                  |
| 54   | 414-183951          | Cable Assembly - Heater Ignition | 1                                      |                  |
| 55   | 414-183959          | Plenum - Heater                  | 1                                      |                  |
| 56   | 112447-S-1C-300T    | Thermostat - Heater              | 1                                      |                  |
| 57   | P-5129 x 5<br>x 132 | Duct - Heater                    | 1                                      |                  |

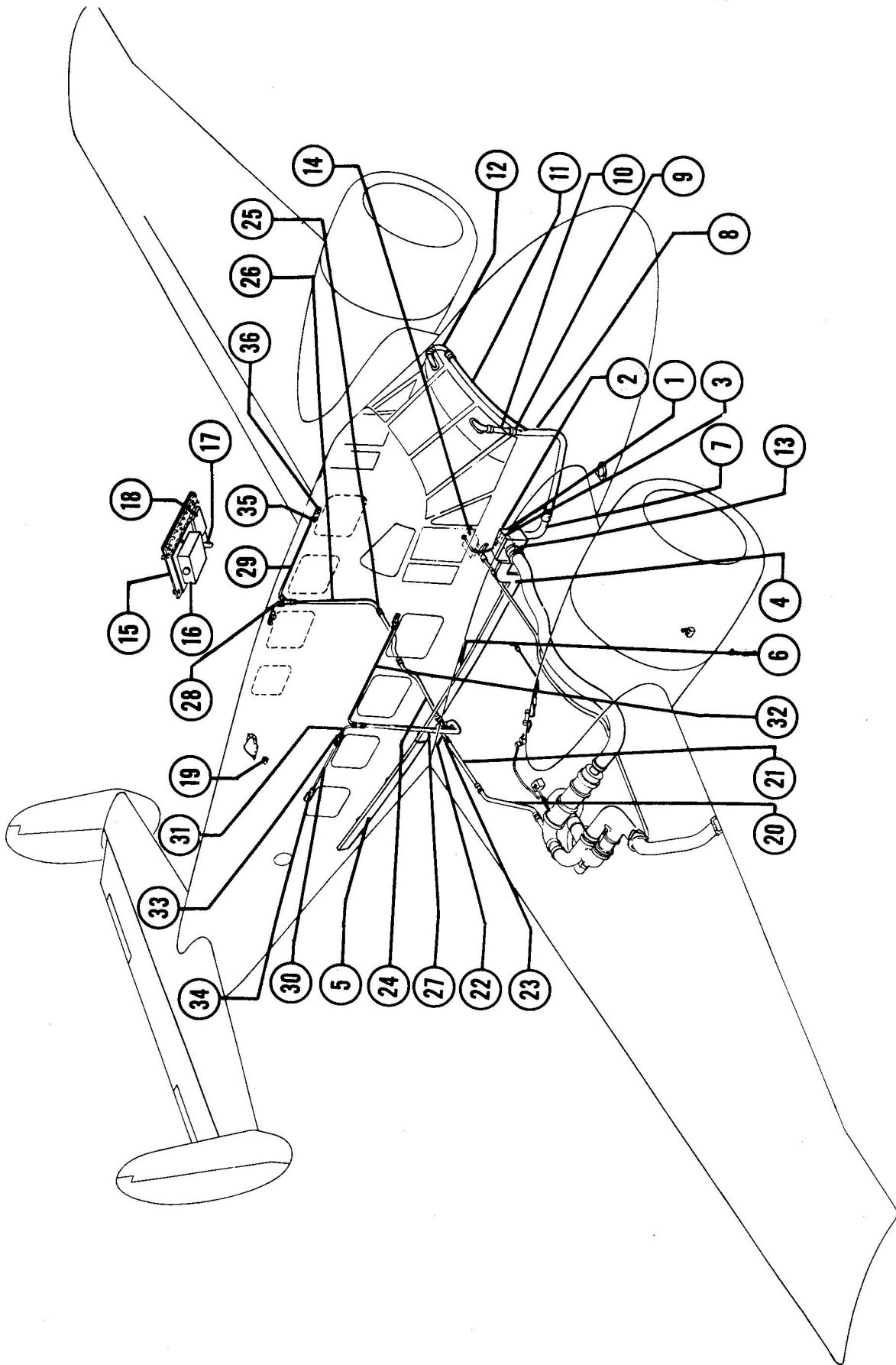

Fig. 38 Cold Air and Heat Ducts

Fig. 38 Cold Air and Heat Ducts

| Fig. | Index | PART NUMBER   | NOMENCLATURE   | Units Per Assem.                |
|------|-------|---|--|---------------------------------|
| 38   |       | 414-183955  | Duct Installation - Fuselage   |                                 |
|      | 1     | 414-183955-37   | Condition Air<br>Box Assembly - Fuselage   | 1                               |
|      | 2     | 414-183955-39   | Distribution<br>Cover - Fuselage Distribution  | 1                               |
|      | 3     | AN515-8-7<br>404-183944   | Box<br>Screw<br>Valve - Fuselage Distribution  | 1<br>20                         |
|      | 4     | AN520-10-14<br>404-183958-16  | Box<br>Screw<br>Control - Fuselage Distribution  | 1<br>3                          |
|      | 5     | 414-183955-29<br>414-183955-7   | Box Valve<br>Duct Assembly - Fuselage<br>Condition Air<br>Duct Assembly - Fuselage           | 1<br>1                          |
|      | 6     | AN515-8-7<br>AN960-8<br>AN365-832<br>100696-D08-06-018<br>AN505-4-16<br>414-183955-11 | Condition Air<br>Screw<br>Washer<br>Nut<br>Spacer<br>Screw<br>Deflector - Fuselage Condition | 1<br>15<br>15<br>15<br>14<br>14 |
|      | 7     | AN515-8-20<br>102933-D3-0250-0875<br>P-5129 x 2 Dia.<br>x 20 Long                     | Air<br>Screw<br>Spacer<br>Duct - Windshield Defroster  | 5<br>20<br>20                   |
|      | 8     | 414-183955-41   | Air<br>Duct - Windshield Defroster   | 1                               |
|      | 9     | AN737TW-74  | Clamp  | 4                               |
|      | 10    | 114632-16-10<br>414-183955-43   | Hose<br>Duct - Windshield Defroster  | 1                               |
|      | 11    | 414-183955-45   | Air<br>Duct - Windshield Defroster   | 1                               |
|      | 12    | P-5129 x 1-1/2<br>Dia x 12 Long   | Air<br>Duct - Windshield Defroster   | 1                               |
|      | 13    | AN737TW-58<br>112447-B-RC-C-150<br>AN526-832R8<br>414-183957                          | Clamp<br>Thermostat - Cycling<br>Screw<br>Panel Installation - Cabin                         | 2<br>4<br>1<br>3                |
|      | 14    | 414-183957-1  | Thermal Control<br>Panel Assembly - Cabin  | 1                               |
|      | 15    | 414-183957-3  | Thermal Control<br>Base - Cabin Thermal Control  | 1                               |
|      | 16    | 53C512  | Box Control  | 1                               |
|      | 17    | NO NUMBER   | Resistor - 3 Ohm 10 Watt<br>(Ohmite)   | 1                               |

| Fig. | Index | PART NUMBER   | NOMENCLATURE                              | Units Per Assem. |
|------|-------|---------------|---|------------------|
| 38   | 18    | 1068          | Fuse Mount (Little Fuse Inc.)             | 1                |
|      |       | NAS-441-3-5   | Fuse                                      | 2                |
|      | 19    | 9653-H2       | Thermostat - Temperature Control          | 1                |
|      |       | 414-183967    | Duct Installation - Individual Cold Air   | 1                |
|      | 20    | 414-183967-9  | Duct - Individual Cold Air                | 1                |
|      | 21    | 414-183967-7  | Duct - Individual Cold Air                | 1                |
|      | 22    | 414-183970    | Elbow - Individual Cold Air               | 1                |
|      |       | AN3-5A        | Bolt                                      | 4                |
|      |       | AN960-10      | Washer                                    | 4                |
|      |       | AN365-1032    | Nut                                       | 4                |
|      | 23    | 114632-16-10  | Hose - Duct Connecting                    | 3                |
|      |       | 105798-8      | Clamp - Hose                              | 6                |
|      | 24    | 414-183967-1  | Duct - Individual Cold Air                | 2                |
|      | 25    | 114632-12-10  | Hose - Duct Connecting                    | 3                |
|      |       | 105798-6      | Clamp - Hose                              | 6                |
|      | 26    | 414-183969    | Duct - Individual Cold Air LH             | 1                |
|      | 27    | 414-183968    | Duct - Individual Cold Air RH             | 1                |
|      |       | 414-180642    | Reading Light and Air Outlet Installation | 1                |
|      | 28    | 414-180642-29 | Tube - Air Outlet Aft LH                  | 1                |
|      | 29    | 414-180642-27 | Tube - Air Outlet Forward LH              | 1                |
|      | 30    | 414-180642-31 | Tube - Air Outlet Aft RH                  | 1                |
|      | 31    | 414-180642-33 | Tube - Air Outlet Center RH               | 1                |
|      | 32    | 414-180642-35 | Tube - Air Outlet Forward RH              | 1                |
|      | 33    | 414-180642-15 | Tee Assembly - Air Outlet                 | 1                |
|      | 34    | 414-180642-17 | Elbow Assembly - Air Outlet               | 4                |
|      | 35    | 114632-8-10   | Hose - Connecting                         | 10               |
|      |       | NAS397-18     | Clamp - Hose                              | 20               |
|      | 36    | 2120          | Valve Assembly - Air Outlet               | 5                |



Fig. 39 Deicer Boots Installation

| Fig. | Index | PART NUMBER   | NOMENCLATURE                             | Units Per Assem. |
|------|-------|---------------|--|------------------|
| 39   |       | 414-180481*   | Boot Installation - Wing Deicer          | 1                |
|      |       | 12-270-13-1   | Boot - Wing Deicer                       | 2                |
|      |       | 12-270-12-1   | Boot - Wing Deicer                       | 2                |
|      |       | 414-180481-1  | Fairing - Deicer Boot                    | 4                |
|      |       | 414-180481-3  | Fairing - Wing Deicer Boot LH            | 1                |
|      |       | 414-180481-4  | Fairing - Wing Deicer Boot RH            | 1                |
|      |       | 414-180481-15 | Frame - Heater Air Inlet                 | 1                |
|      |       | 414-180482-1* | Boot Installation - Stabilizer Deicer LH | 1                |
|      |       | 414-180482-2* | Boot Installation - Stabilizer Deicer RH | 1                |
|      |       | 414-180482-3  | Cover - Stabilizer Deicer Boot LH        | 1                |
|      |       | 414-180482-4  | Cover - Stabilizer Deicer Boot RH        | 1                |
|      |       | 414-180482-5  | Cover - Stabilizer Deicer Boot LH        | 1                |
|      |       | 414-180482-6  | Cover - Stabilizer Deicer Boot RH        | 1                |

\*Optional Equipment

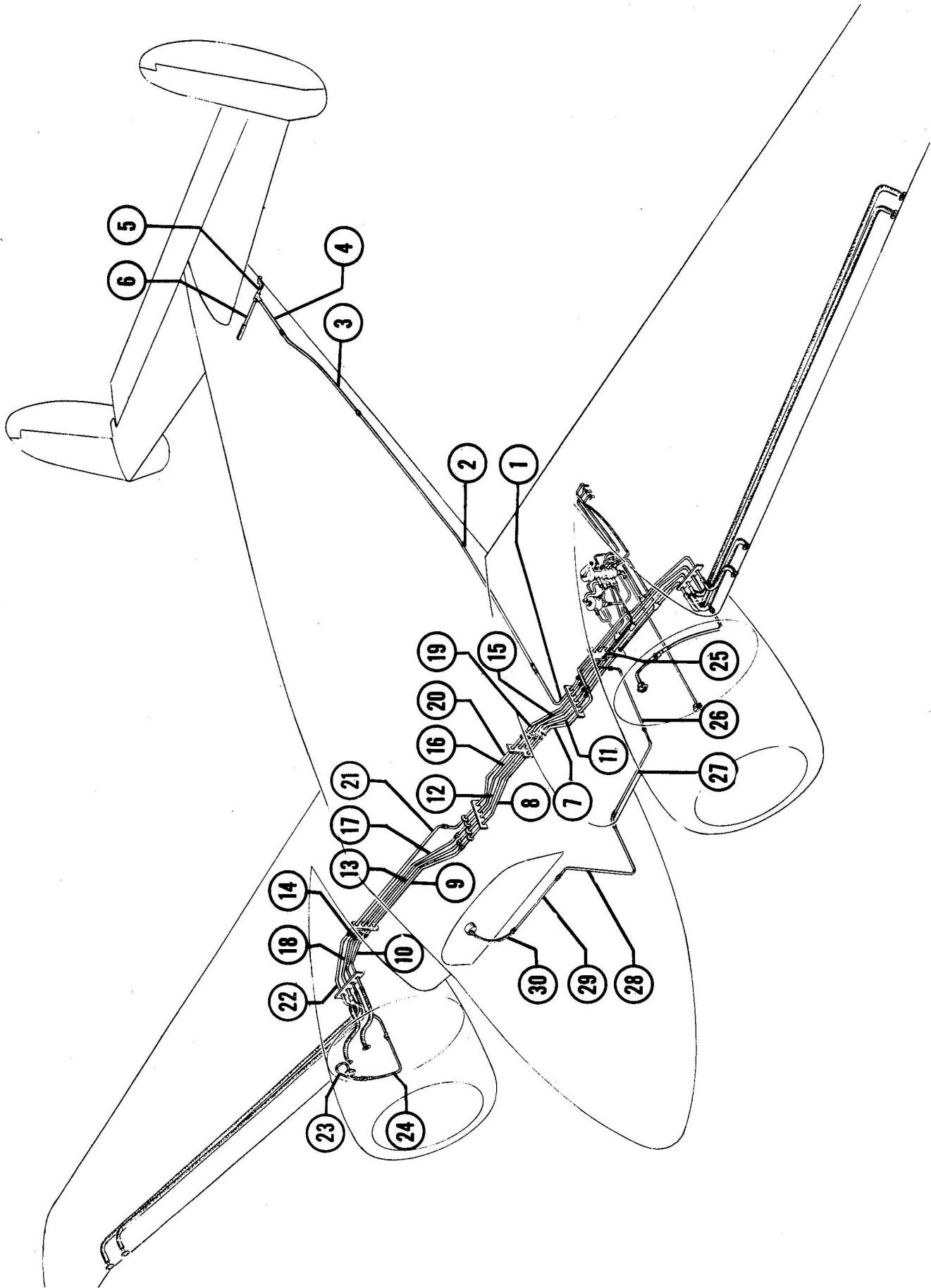

**Fig. 40 Deicer Plumbing Installation**

Fig. 40 Deicer Plumbing Installation

| Fig. | Index | PART NUMBER    | NOMENCLATURE  | Units Per Assem. |
|------|-------|----------------|---|------------------|
| 40   |       | 414-189690*    | Deicer System Installation                                    | 1                |
|      | 1     | 414-189690-107 | Tube Assembly - Deicer<br>Tail Surface Boots                  | 1                |
|      | 2     | 414-189690-236 | Tube Assembly - Deicer<br>Tail Surface Boots                  | 1                |
|      | 3     | 414-189690-139 | Tube Assembly - Deicer<br>Tail Surface Boots                  | 1                |
|      | 4     | 414-189690-143 | Tube Assembly - Deicer Tail<br>Surface Boots                  | 1                |
|      | 5     | 414-189690-111 | Tube Assembly - Deicer Tail<br>Surface Boot                   | 1                |
|      | 6     | 414-189690-115 | Tube Assembly - Deicer Tail<br>Surface Boot                   | 1                |
|      | 7     | 414-189690-219 | Tube Assembly - Deicer Right<br>Wing Center Boot              | 1                |
|      | 8     | 414-189690-291 | Tube Assembly - Deicer Right<br>Wing Center Boot              | 1                |
|      | 9     | 414-189690-207 | Tube Assembly - Deicer Right<br>Wing Center Boot              | 1                |
|      | 10    | 414-189690-25  | Tube Assembly - Deicer Right<br>Wing Center Boot              | 1                |
|      | 11    | 414-189690-223 | Tube Assembly - Deicer Right<br>Wing Tip Boot                 | 1                |
|      | 12    | 414-189690-231 | Tube Assembly - Deicer Right<br>Wing Tip Boot                 | 1                |
|      | 13    | 414-189690-203 | Tube Assembly - Deicer Right<br>Wing Tip Boot                 | 1                |
|      | 14    | 414-189690-21  | Tube Assembly - Deicer Right<br>Wing Tip Boot                 | 1                |
|      | 15    | 414-189690-227 | Tube Assembly - Deicer Right<br>Wing Upper and Lower<br>Boots | 1                |
|      | 16    | 414-189690-295 | Tube Assembly - Deicer Right<br>Wing Upper and Lower<br>Boots | 1                |
|      | 17    | 414-189690-199 | Tube Assembly - Deicer Right<br>Wing Upper and Lower<br>Boots | 1                |
|      | 18    | 414-189690-17  | Tube Assembly - Deicer Right<br>Wing Upper and Lower<br>Boots | 1                |
|      | 19    | 414-189690-215 | Tube Assembly - Right Engine<br>Vacuum Separator              | 1                |
|      | 20    | 414-189690-299 | Tube Assembly - Right Engine<br>Vacuum Separator              | 1                |
|      | 21    | 414-189690-211 | Tube Assembly - Right Engine<br>Vacuum Separator              | 1                |
|      | 22    | 414-189690-13  | Tube Assembly - Right Engine<br>Vacuum Separator              | 1                |
|      | 23    | 414-189690-135 | Tube Assembly - Right Engine<br>Vacuum Separator              | 1                |
|      | 24    | 414-189690-131 | Tube Assembly - Right Engine<br>Vacuum Separator              | 1                |

| Fig. | Index | PART NUMBER | NOMENCLATURE                            | Units Per Assem. |
|------|-------|-------------|---|------------------|
| 40   | 25    | 734-189681  | Tube Assembly - Deicer<br>Pressure Gage | 1                |
|      | 26    | 734-189682  | Tube Assembly - Deicer<br>Pressure Gage | 1                |
|      | 27    | 734-189685  | Tube Assembly - Deicer<br>Pressure Gage | 1                |
|      | 28    | 404-189598  | Tube Assembly - Deicer<br>Pressure Gage | 1                |
|      | 29    | 404-189828  | Tube Assembly - Deicer<br>Pressure Gage | 1                |
|      | 30    | AN6270-4-12 | Hose Assembly - Deicer                  | 1                |
|      |       |             | Pressure Gage                           | 1                |

\*Optional Equipment

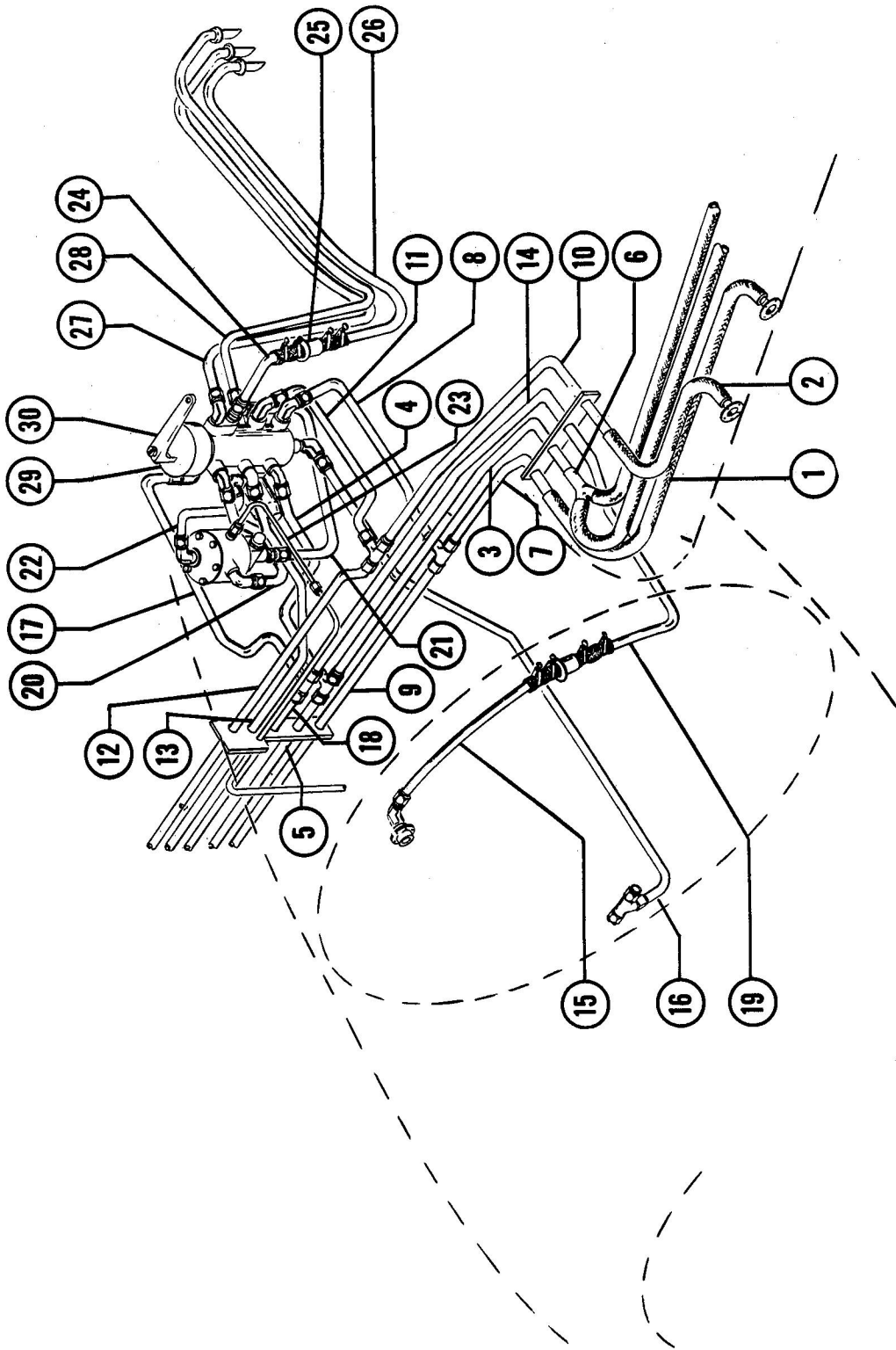

Fig. 41 Deicer Plumbing Detail

Fig. 41 Deicer Plumbing Detail

| Fig. | Index | PART NUMBER    | NOMENCLATURE   | Units Per Assem. |
|------|-------|----------------|--|------------------|
| 41   | 1     | 414-189690-43* | Hose - Deicer Boot Outboard                                      | 4                |
|      | 2     | 414-189690-311 | Hose - Deicer Boot Inboard                                       | 4                |
|      | 3     | 414-189690-33  | Tube Assembly - Deicer Left Wing Upper and Lower Boot            | 1                |
|      | 4     | 414-189690-155 | Tube Assembly - Deicer Left and Right Wing Upper and Lower Boots | 1                |
|      | 5     | 414-189690-191 | Tube Assembly - Deicer Right Wing Upper and Lower Boots          | 1                |
|      | 6     | I189673        | Nipple - Double  | 2                |
|      | 7     | 414-189690-29  | Tube Assembly - Deicer Left Wing Tip Boot                        | 1                |
|      | 8     | 414-189690-151 | Tube Assembly - Deicer Left and Right Wing Tip Boot              | 1                |
|      | 9     | 414-189690-179 | Tube Assembly - Deicer Right Wing Tip Boot                       | 1                |
|      | 10    | 414-189690-41  | Tube Assembly - Deicer Left Wing Center Boot                     | 1                |
|      | 11    | 414-189690-167 | Tube Assembly - Deicer Left and Right Wing Center Boot           | 1                |
|      | 12    | 414-189690-187 | Tube Assembly - Deicer Right Wing Tip Boot                       | 1                |
|      | 13    | 414-189690-159 | Tube Assembly - Deicer Tail Boots                                | 1                |
|      | 14    | 414-189690-37  | Tube Assembly - Left Engine Vacuum Separator                     | 1                |
|      | 15    | 414-189690-127 | Tube Assembly - Left Engine Vacuum Separator                     | 1                |
|      | 16    | 414-189690-195 | Tube Assembly - Left Engine Vacuum Separator                     | 1                |
|      | 17    | 414-189690-103 | Tube Assembly - Left and Right Engine Vacuum Separator           | 1                |
|      | 18    | 414-189690-183 | Tube Assembly - Right Engine Vacuum Separator                    | 1                |
|      | 19    | 414-189690-53  | Tube Assembly - Vacuum Line                                      | 1                |
|      | 20    | 414-189690-171 | Tube Assembly - Oil Separator                                    | 1                |
|      | 21    | 414-189690-123 | Tube Assembly - Oil Separator                                    | 1                |
|      | 22    | 414-189690-175 | Tube Assembly - Oil Separator                                    | 1                |
|      | 23    | 414-189690-147 | Tube Assembly - Pressure Gage                                    | 1                |
|      | 24    | 414-189690-119 | Tube Assembly - Vent   | 1                |
|      | 25    | W1500-5/8      | Valve - Check  | 3                |
|      | 26    | 414-189690-99  | Tube Assembly - Vent   | 1                |
|      | 27    | 414-189690-95  | Tube Assembly - Vent   | 1                |
|      | 28    | 414-189690-49  | Tube Assembly - Vent   | 1                |
|      | 29    | 414-189682     | Valve Assembly - Distributor                                     | 1                |
|      | 30    | I189669        | Control - Distributor Valve                                      | 1                |

\*Optional Equipment

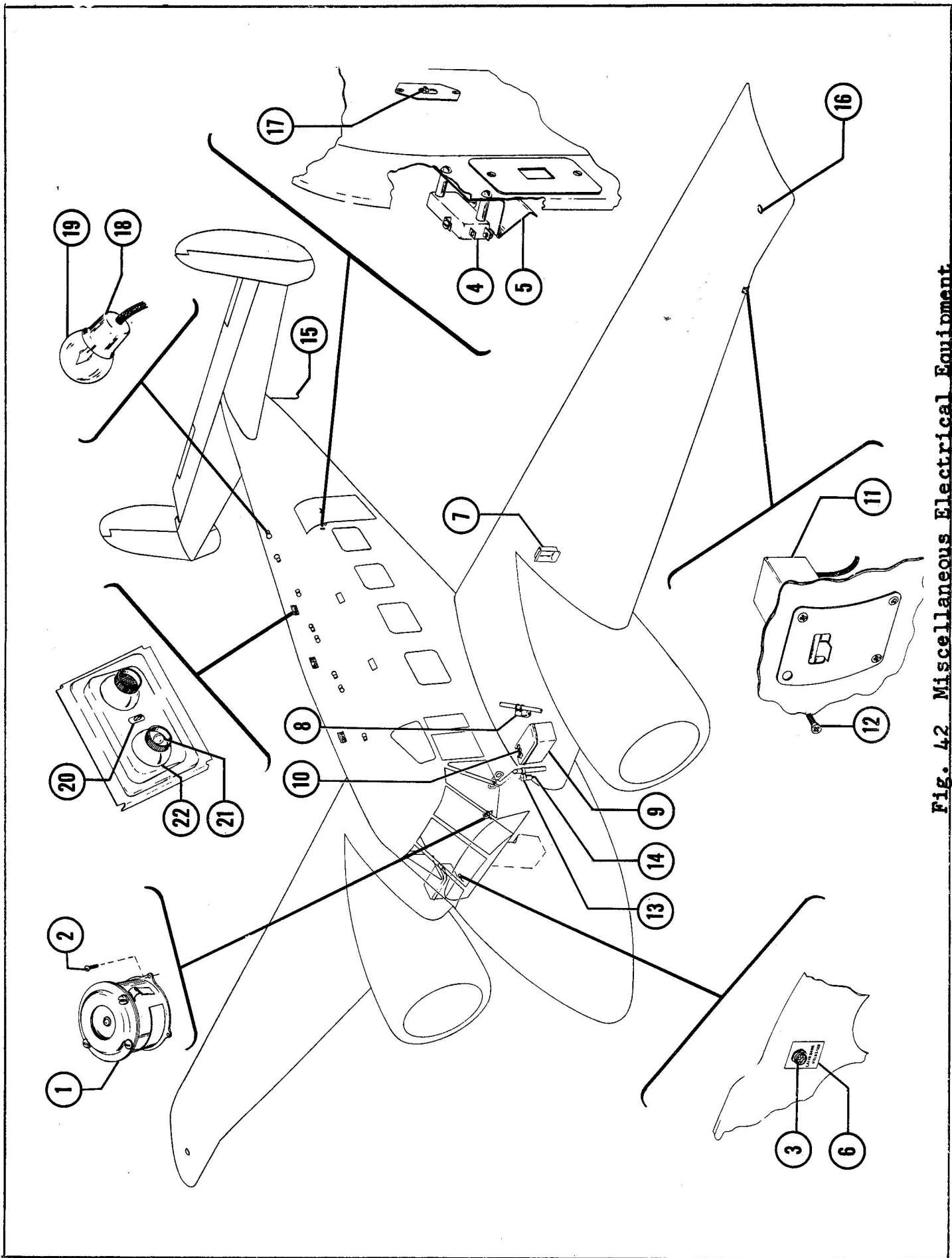

Fig. 42 Miscellaneous Electrical Equipment.

Fig. 42 Miscellaneous Electrical Equipment

| Fig. | Index | PART NUMBER    | NOMENCLATURE                                       | Units Per Assem. |
|------|-------|----------------|--|------------------|
| 42   |       | 414-180540     | Electrical Installation - Fuselage                 | 1                |
|      | 1     | 318            | Horn - Landing Gear Warning                        | 1                |
|      | 2     | AN515-8-16     | Screw  | 3                |
|      |       | 414-180542     | Light Installation - Cabin Door Warning            | 1                |
|      | 3     | AN3157-6       | Light Assembly - Cabin Door Warning                | 1                |
|      | 4     | AN3234-3       | Switch - Cabin Door Warning Light                  | 2                |
|      | 5     | 414-180542-3   | Spring - Cabin Door Warning Light Switch           | 2                |
|      | 6     | 414-180011     | Placard - Cabin Door Warning Light                 | 1                |
|      |       | 414-180590     | Electrical Installation - Center Section           | 1                |
|      | 7     | 45-361082      | Cover - Belly Terminal Strip                       | 1                |
|      |       | 414-189410     | Electrical Installation - Battery                  | 1                |
|      | 8     | AN3370-1       | Relay - Battery                                    | 1                |
|      | 9     | R-33           | Battery - (Reading Battery Inc.)                   | 2                |
|      | 10    | 414-189412     | Buss - Battery                                     | 1                |
|      |       | 414-180550     | Electrical Installation - Nacelle LH               | 1                |
|      |       | 414-180551     | Electrical Installation - Nacelle RH               | 1                |
|      |       | 414-180611     | Unit Installation - Stall Warning                  | 1                |
|      | 11    | 180F           | Unit - Stall Warning (Safe Flight Instrument Corp) | 1                |
|      | 12    | AN507-632-8    | Screw  | 4                |
|      |       | 414-180612     | Shaker Installation - Control Stick                | 1                |
|      | 13    | 21500          | Unit - Control Stick Shaker                        | 1                |
|      | 14    | AN3106-10SL-4S | Plug - Electrical                                  | 1                |
|      |       | 414-180820     | Ground Installation - Static                       | 1                |
|      | 15    | 414-180820-3   | Mast Assembly - Static Ground                      | 1                |
|      |       | 414-180690     | Equipment Installation - Outboard Wing Electrical  | 1                |
|      | 16    | A-2138         | Light Assembly - Position (Grimes Mfg. Co.)        | 4                |
|      |       | 414-181500-61  | Lense - LH Top                                     | 1                |
|      |       | 414-181500-63  | Lense - RH Top                                     | 1                |
|      |       | 414-181500-62  | Lense - LH Bottom                                  | 1                |
|      |       | 414-181500-64  | Lense - RH Bottom                                  | 1                |
|      |       | 414-180641     | Light Installation - Cabin Dome                    | 1                |
|      | 17    | AN3209-3       | Switch - Cabin Dome Light                          | 1                |
|      | 18    | SC-2611        | Socket - Cabin Dome Light                          | 8                |
|      | 19    | 1185           | Bulb - Cabin Dome Light                            | 8                |
|      |       | 414-180642     | Light Installation - Reading and Air Outlet        | 1                |
|      | 20    | AN3209-3       | Switch - Cabin Reading Light                       | 5                |
|      | 21    | 1495           | Bulb - Cabin Reading Light (General Electric Corp) | 5                |
|      | 22    | B2180          | Light Assembly - Cabin Reading                     | 5                |



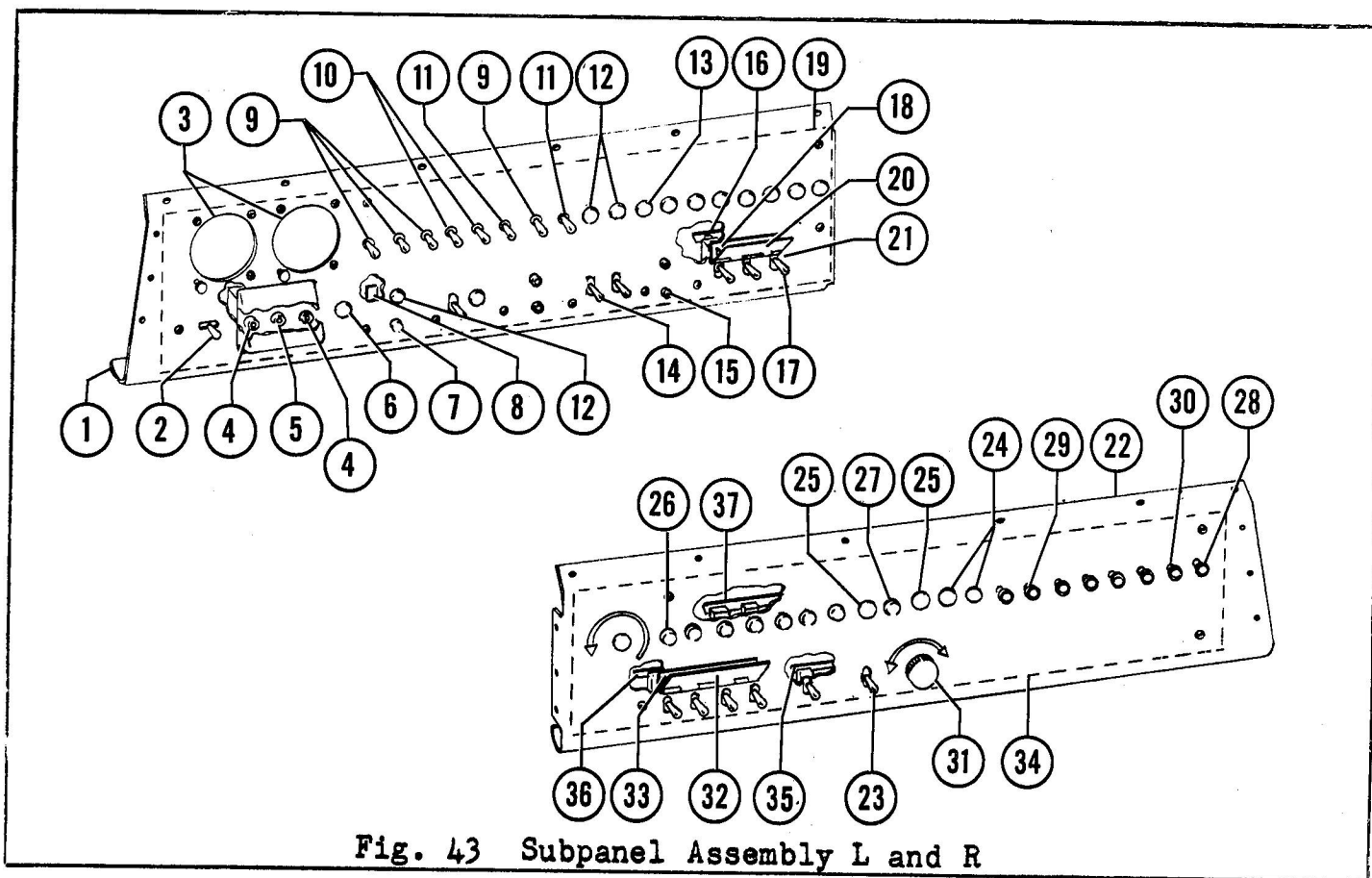

Fig. 43 Subpanel Assembly L and R

| Fig. | Index | PART NUMBER  | NOMENCLATURE   | Units Per Assem. |
|------|-------|--------------|--|------------------|
| 43   |       | 414-183750   | Panel Assembly - Sub LH Complete   | 1                |
|      | 1     | 414-183750-3 | Panel - Sub  | 1                |
|      | 2     | AN3226-1     | Switch - Starter Selector  | 1                |
|      | 3     | 50-320123    | Indicator - Volt Ammeter   | 2                |
|      | 4     | 138143       | Switch - Ignition Booster and Primer (Ucinite Co. Los Angeles, California) | 2                |
|      | 5     | 138143E      | Switch - Starter   | 1                |
|      | 6     | 404-183798   | Button - Plug  | 2                |
|      | 7     | PSM-10       | Breaker - Circuit (Spencer Thermostat Co.)                                 | 3                |
|      | 8     | 108446-2     | Bus  | 2                |
|      | 9     | 8730K3-5A    | Breaker - Circuit (Cutler Hammer)  | 4                |
|      | 10    | 8731K3-10A   | Breaker - Circuit (Cutler Hammer)  | 2                |
|      | 11    | 8733K3-20A   | Breaker - Circuit (Cutler Hammer)  | 2                |
|      | 12    | 48182        | Button - Plug ( United Carr)   | 3                |
|      | 13    | 48152        | Button - Plug (United Carr)  | 8                |
|      | 14    | AN3021-1     | Switch - Landing Light   | 3                |
|      | 15    | PSM-30       | Breaker - Circuit  | 2                |
|      | 16    | 108446-3     | Buss   | 2                |
|      | 17    | AN3021-3     | Switch - Battery and Generator   | 4                |
|      | 18    | 180006       | Placard - Master Switch  | 1                |

| Fig. | Index | PART NUMBER           | NOMENCLATURE                               | Units Per Assem. |
|------|-------|-----------------------|--|------------------|
| 43   | 19    | 414-183752            | Placard - Subpanel LH                      | 1                |
|      | 20    | 414-183750-13         | Throw Assembly - Master Switch             | 1                |
|      | 21    | 105774-C-090<br>00224 | Pin - Hinge                                | 1                |
|      |       | 414-183750-19         | Spring - Oil Dilution Switch Return        | 2                |
|      |       | 414-183751            | Panel Assembly - Sub RH Complete           | 1                |
|      | 22    | 414-183751-3          | Panel - Sub RH                             | 2                |
|      | 23    | AN3021-3              | Switch                                     | 6                |
|      | 24    | 48182                 | Button - Plug                              | 3                |
|      | 25    | 48152                 | Button - Plug                              | 2                |
|      | 26    | 49B6768-10            | Breaker - Circuit                          | 7                |
|      | 27    | 49B6768-5             | Breaker - Circuit                          | 1                |
|      | 28    | PSM-10                | Breaker - Circuit (Spencer Thermostat Co.) | 5                |
|      | 29    | PSM-15                | Breaker - Circuit (Spencer Thermostat Co.) | 2                |
|      | 30    | PSM-20                | Breaker - Circuit (Spencer Thermostat Co.) | 1                |
|      | 31    | 0158-355              | Rheostat - Cabin Heater                    | 1                |
|      | 32    | 404-183707            | Throw Assembly - Master Switch             | 1                |
|      | 33    | 180006                | Placard - Master Switch                    | 1                |
|      | 34    | 414-183753            | Placard - Subpanel RH                      | 1                |
|      | 35    | 108446-3              | Bus  | 1                |
|      | 36    | 108446-4              | Bus  | 1                |
|      | 37    | 108446-10             | Bus  | 2                |
|      | 38    | 414-183751-11         | Box Assembly - Subpanel RH                 | 1                |
|      |       | 414-183751-13         | Lid - Magneto Box RH Subpanel              | 1                |

Fig. 44 Miscellaneous Tools and Equipment

| Fig. | Index | PART NUMBER | NOMENCLATURE   | Units Per Assem. |
|------|-------|-------------|--|------------------|
| 44   |       | 414-180020  | Equipment Installation -<br>Loose Tools and Equipment        | 1                |
|      |       | 404-188035  | Wrench Assembly - Landing<br>Gear Nut                        | 1                |
|      |       | PWA2525     | Tool Kit - Engine  | 1                |
|      |       | 123440      | Overhaul Manual - Pratt<br>and Whitney                       | 1                |
|      |       | 116940      | Operators Manual - Pratt<br>and Whitney                      | 3                |
|      |       | NO NUMBER   | Book - Engine Log  | 2                |
|      |       | 404-180261  | Calculator Assembly - Weight<br>and Balance                  | 1                |
|      |       | 414-180155  | Supplement - Model E-18<br>and Maintenance Manual            | 1                |
|      |       | 113666      | Publication - Safety<br>Suggestions                          | 1                |
|      |       | 113667      | Directory - Beechcraft<br>Certified Service<br>Stations      | 1                |
|      |       | 113668      | Publication - Facts Every<br>Aircraft Owner Should<br>Know   | 1                |
|      |       | 113669      | Publications - G's   | 1                |
|      |       | 113670      | Publication - Kinetikos                                      | 1                |
|      |       | 113671      | Publication - Laws of Judge<br>Nature                        | 1                |
|      |       | 113672      | Application Letter - Hertz<br>Drive-ur-Self Courtesy<br>Card | 1                |
|      |       | 414-180109  | List - Pilots Check Off                                      | 1                |
|      |       | 414-180156  | Manual - CAA Airplane<br>Flight                              | 1                |
|      |       | 414-180157  | Handbook - Model E18S<br>Flight                              | 1                |

